

BLACK+
DECKER

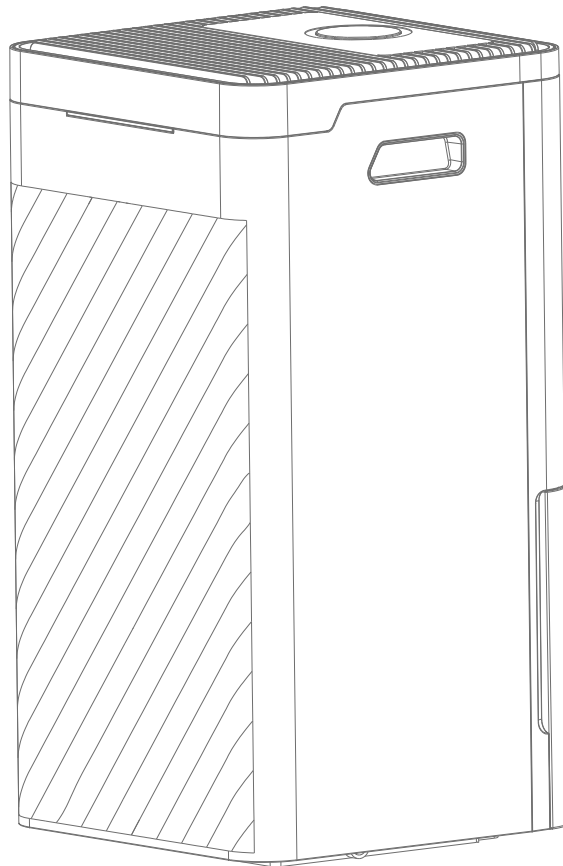

www.blackanddecker.co.uk

BXEH60003GB

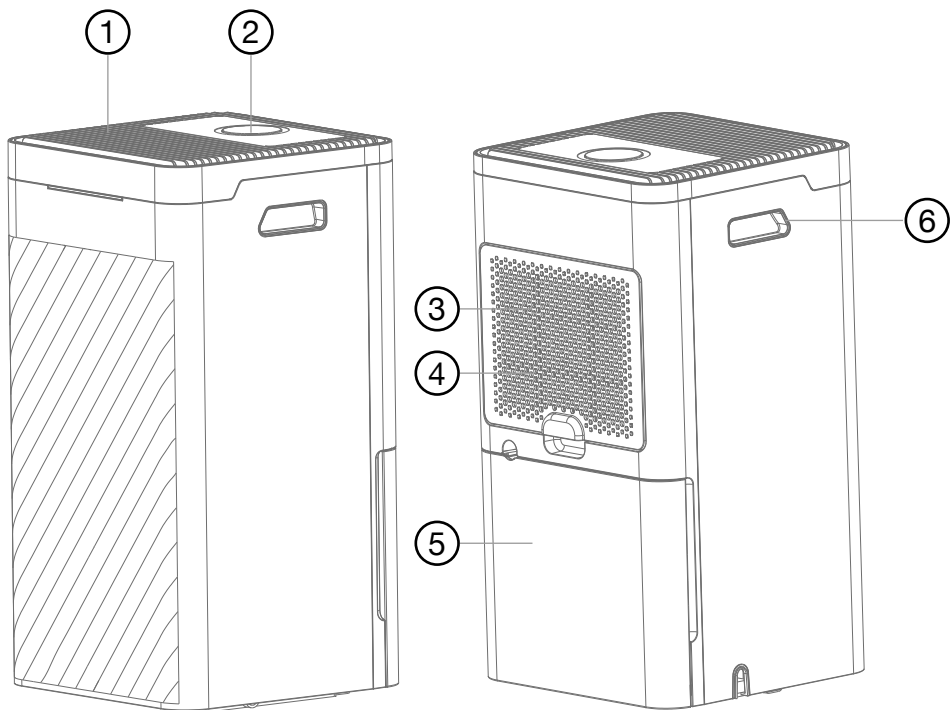

What's in the box

Instruction Manual
Dehumidifier

Features

- | | |
|------------------|---------------|
| 1. Air outlet | 5. Water tank |
| 2. Control panel | 6. Handle |
| 3. Air inlet | |
| 4. Filter | |

Intended Use

Your BLACK+DECKER BXEH60003GB 12L Dehumidifier has been designed for small and medium spaces.

This appliance is intended for indoor household use only.

Thank you for choosing BLACK+DECKER. We hope that you will enjoy using this product for many years.

Safety Instructions

▲WARNING: Read all safety warnings and all instructions. Failure to follow the warnings and instructions listed below may result in electric shock, fire and/or serious injury.

- ◆ Read this manual carefully before using the appliance.
- ◆ The intended use is described in this manual.
- ◆ The use of any accessory or attachment or the performance of any operation with this appliance other than those recommended in this instruction manual may present a risk of personal injury.
- ◆ Retain this manual for future reference.
- ◆ **▲WARNING:** When using mains-powered appliances, basic safety precautions, including the following, should always be followed to reduce the risk of fire, electric shock, personal injury and material damage.

Using Your Appliance

Please read the operating instructions carefully before using your appliance for the first time.

- ◆ Check that the voltage of the main circuit corresponds with the rating of the appliance before operating.
- ◆ Children shall not play with the appliance.
- ◆ Do not let the cable hang over the edge of a table or counter or let it come into contact with any hot surfaces.
- ◆ The use of accessory attachments is not recommended by the appliance manufacturer, apart from those supplied with this product.
- ◆ Do not pull the plug out by the cable as this may damage the plug and/or the cable.
- ◆ Do not use this product for anything other than its intended use.
- ◆ This appliance is for household use only.
- ◆ Do not carry the appliance by the power cable.
- ◆ Do not use the appliance outdoors.
- ◆ Do not operate with wet hands.
- ◆ Use of an extension cable with this appliance is not recommended. However, if it is necessary to use an extension lead, ensure that the lead is suited to the power consumption of the appliance to avoid overheating of extension cable, appliance or plug point. Do not place the extension cable in a

position where it can be pulled on by children or animals or tripped over.

- ◆ Always unplug the unit when not in use or before cleaning.
- ◆ The manufacturer does not accept responsibility for any damage or injury caused by improper or incorrect use, or for repairs carried out by unauthorised personnel.

Safety Of Others

- ◆ Close supervision is necessary when any appliance is used by or near children.
- ◆ Children should not play with the appliance.
- ◆ This appliance can be used by children aged from 8 years and above and persons with reduced physical, sensory or mental capabilities or lack of experience and knowledge if they have been given supervision or instruction concerning use of the appliance in a safe way and understand the hazards involved.
- ◆ Cleaning and user maintenance should not be undertaken by children without supervision.
- ◆ Take care when any appliance is used near pets.
- ◆ Do not allow the cord to become twisted.

After Use

- ◆ While cleaning, DO NOT use a wet cloth or use water on any part of the unit, as this may cause a short circuit or electrical shock.
- ◆ Keep this unit clean. Do not allow objects to enter the ventilation opening as this may cause electric shock, or damage to the unit. Switch off the unit and then remove the plug from the socket when not in use or before cleaning.
- ◆ Check all inlets and outlets regularly for accumulated dust.
- ◆ Disconnect the unit from mains outlet when it is not in use, or before relocating or cleaning it.
- ◆ Switch off and remove the plug from the socket before leaving the appliance unattended and before changing, cleaning or inspecting any parts of the appliance.
- ◆ When not in use, the appliance should be stored in a dry place. Children should not have access to stored appliances.

Inspections And Repairs

- ◆ Do not attempt to dismantle, repair or remould any part of the unit. This should only be done by a qualified service agent. Even the change of power cable should be done by a qualified person.

- ◆ In the unlikely event the appliance develops a fault, stop using it immediately and seek advice from the manufacturer.
- ◆ In case of technical problems, switch off the product and do not attempt to repair it yourself. Return the appliance to an authorised service facility for examination, adjustment or repair. Always insist on the use of original spare parts. Failure to comply with the above mentioned precautions and instructions, could affect the safe operation of this product.

Additional safety instructions for Dehumidifiers

- ◆ Install the unit on flat and hard floor to diminish vibration or noise.
- ◆ Always operate the appliance on a smooth, even, stable surface. Do not place the unit on a hot surface.
- ◆ Ensure that the unit is switched off after use.
- ◆ Do not immerse cables, plugs or any part of the appliance in water or any other liquid.
- ◆ Operate the unit only at the voltage specified.
- ◆ Do not use the unit near open windows, as contact with rain and other natural elements could cause an electrical hazard
- ◆ Do not put heavy objects on the appliance.
- ◆ Do not tip the unit on its side.

- ◆ Never insert any other object into the unit body to avoid any hazard or unit failure.
 - ◆ Do not put the unit close to heat-generating devices or near flammable and dangerous materials.
 - ◆ If the supply cable is damaged, it must be replaced by the manufacturer or its service agent or a similarly qualified person in order to avoid a hazard
 - ◆ The appliance must be positioned so that the plug is accessible.
- ⚠WARNING:** Do not place the unit on or near a hot gas electric burner.

Safety relating to refrigerant R290:

- ◆ These symbols on your device mean:
- ◆ This appliance is filled with Propane gas R290. ALWAYS follow the manufacturer's instruction concerning use and repairs.
- ◆ Read the entire instruction manual carefully before attempting to use the appliance.
- ◆ Do not install, operate or store the device in a room smaller than 4m².



Warning: Risk of fire



Please read operator's manual carefully!



Please read operating instructions carefully!



Please read technical manual carefully!

- ◆ Read these warnings carefully.

- ◆ This appliance contains approximately 45g of R290 refrigerant. R290 is a refrigerant that complies with the relevant European Directives. Never perforate the refrigerant circuit.

CAUTION: R290 is flammable (GWP3)!

- ◆ DO NOT use any processes to clean the unit or accelerate the defrosting process, other than those recommended by the manufacturer.
 - ◆ DO NOT store the appliance in a room containing other continuously operating ignition sources (for example: open flames, an operating gas appliance or an operating electric heater).
 - ◆ DO NOT pierce or burn any of the components of the cooling circuit of the unit. DO NOT set the unit on fire.
 - ◆ Take care to store the appliance in such a way as to prevent mechanical faults or damage from occurring.
 - ◆ DO NOT install, operate or store the appliance in a room with a floor area of less than 4m².
 - ◆ Be aware that the refrigerant may be odourless, and that leaks may not be detectable by smell.
 - ◆ ALWAYS take care to comply with national gas regulations.
 - ◆ Keep ventilation openings clear of obstruction.
- ◆ Store the appliance in a well-ventilated area where the room size corresponds to the room area specified for operation.
 - ◆ Any person who is involved with working on or breaking into a refrigerant circuit should hold a current valid certificate from an industry-accredited assessment authority, which authorises their competence to handle refrigerants safely in accordance with an industry recognised assessment specification.
 - ◆ Servicing shall only be performed on the grounds recommended by the equipment manufacturer. Maintenance and repair requiring the assistance of other skilled personnel shall be carried out under the supervision of the person competent in the use of flammable refrigerants.

▲WARNING: Do not place the unit on or near a hot gas electric burner.

Electrical safety

Before use, check that the mains voltage corresponds to the voltage on the rating plate.



This product must be earthed. Always check that the mains voltage corresponds to the voltage on the rating plate.

- ◆ Appliance plugs must match the outlet. Never modify the plug in any way.
- ◆ Do not use any adapter plugs with earthed (Class 1) appliances. Unmodified plugs and matching outlets will reduce the risk of electric shock.
- ◆ To avoid the risk of electric shock, do not immerse the cord, plug or appliance in water or other liquid.

Extension cables & class 1 product

- ◆ A 3 core cable must be used as your tool is earthed and of class 1 construction.
- ◆ Up to 30m (100 ft) can be used without loss of power.
- ◆ If the supply cord is damaged, it must be replaced by the manufacturer or an authorised BLACK+DECKER Service Centre in order to avoid a hazard.

▲WARNING: Before assembling, switch the appliance off and remove the plug from the socket.

Features

1. Air outlet
2. Control panel
3. Air inlet
4. Filter
5. Water tank
6. Handle

Use

About the Controls

- ◆ Dry clothes
- ◆ Normal Operation
- ◆ Continuous Operation
- ◆ Ventilation
- ◆ Sleep Mode

Operation and Efficiency

- ◆ This appliance operates in temperatures between 5-32°C.

Defrosting operation

- ◆ The evaporator in the dehumidifier may defrost automatically if it is operated in a room temperature less than 18°C. Defrosting may start up and operate for some time (about 5 minutes), automatically approximately every 25 minutes. The defrost light  will illuminate.
- ◆ During the defrosting operation, the dehumidification function and air purification function may intermit.
- ◆ Please don't turn off or pull out the power plug of the dehumidifier during the defrosting operation.
- ◆ The purpose of this dehumidifier is to remove high humidity and dampness, not to keep temperatures low.
- ◆ This dehumidifier doesn't have a cooling function. It will produce heat during the operation and increase the room temperature by 1 to 4°C. This temperature rise may be very distinct in small spaces.

Control Panel

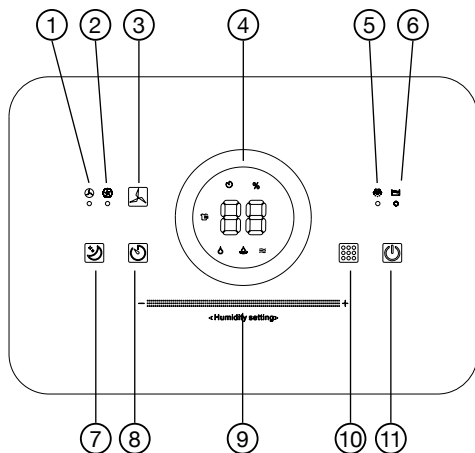

1. Low fan speed indicator
2. High fan speed indicator
3. Fan speed selector
4. LED display (Humidity, Timer & Modes)
5. Defrost indicator
6. Water tank full indicator
7. Sleep button
8. Timer button
9. Humidity & timer touch control slider
10. Mode button
11. ON/OFF button

Turning The Unit On Or Off

Note: To avoid damage, place the unit in an upright position for at least 24 hours before first use.

Note: Always ensure the water tank is empty and in place before turning the unit on.

Note: During the operation, keep doors and windows closed to save energy.





- ◆ To power the unit on, first plug it into a mains socket. A single beep will be heard. The unit will be in stand-by mode.
- ◆ Press the ON/OFF button  to turn the unit on. The ON/OFF button and the fan speed light on the unit's control panel will illuminate and air will start emitting from the top grille. The display screen will show the current room humidity %.
- ◆ Press the ON/OFF button again to power the unit off. Air will stop emitting from the grille to show the unit has been powered down. All lights will go off.

- ◆ To shut the unit off completely, unplug it from the mains socket.

⚠WARNING: DO NOT store the unit immediately after turning it off. Allow time for the unit to cool down before storing.

Dehumidification Modes

There are 4 modes to select from:



-  - Normal dehumidification – adjustable fan speed and adjustable humidity
-  - Continuous dehumidification – a set low fan speed and humidity is not adjustable
-  - Ventilation mode – adjustable fan speed and humidity is not adjustable
-  - Drying mode – a set high fan speed and set humidity is not adjustable

Press the mode button  to cycle through the options, respective symbols will show in the display. The mode selected will flash for 5 seconds and then remain visible in the display.

Humidity Setting

- ◆ In Normal dehumidification mode, slide your finger across the symbol  horizontally to set the humidity between 30%-80% (in increments of 5%).
- ◆ The humidity selected will flash for 5 seconds in the display.
- ◆ The display will then show the room's current humidity.
- ◆ To check the humidity selected at any time, press the humidity setting symbol and it will flash in the display for 5 seconds.

Timer Operation

- ◆ Whilst the unit is operating the timer is used to set the time to turn the appliance off.
- ◆ Whilst the unit is in stand-by mode the timer is used to set the time to turn the appliance on.
- ◆ Press the timer button  to select a time between 1-24hrs.
- ◆ With each press of the timer button the time will increase by 1 hour. The time selected will flash for 5 seconds and the  will illuminate in the display.
- ◆ To check the time selected at any time, press the timer button and it will flash in the display for 5 seconds.

- ◆ To cancel the timer, press the timer button until the time shows 00.

Fan Speed

- ◆ The fan speed can only be changed in Normal and Ventilation modes.



- Low fan speed



- High fan speed

- ◆ Press the fan speed button  to cycle through the low and high speed settings. The respective light will illuminate.

Sleep

Press the sleep button  to enter sleep mode. The sleep button light illuminates and the display turns off.

Press the sleep button  again to switch the Sleep function off. The light will go off and the display will come on.

Removing The Water Tank

- ◆ Ensure the water tank is empty before turning the unit on.
- ◆ **▲WARNING:** Do not drink the water or use for other purposes.

Continuous drainage (optional)

- ◆ By connecting a water pipe in to the back of the appliance water can be drained continuously.
- ◆ Remove the water tank. Insert the pipe, ensuring that the pipe is firmly connected to the drainage mouth.

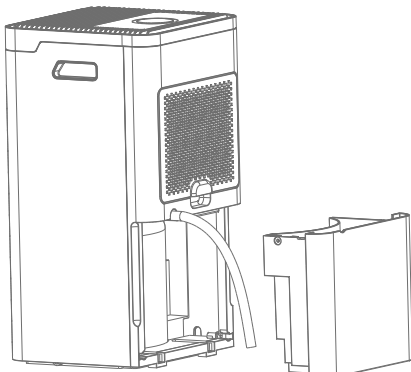

Note: The drainage hose should not be installed outdoors at low temperatures.

Drainage Manually

- ◆ When the water tank is full, the water-full indicator is will illuminate and the unit will stop working.
- ◆ Pull out the water tank and pour away the water.
- ◆ Replace the water tank. The dehumidifier will restart.

Note: Before putting in the water tank, please ensure the float inside it moves freely.

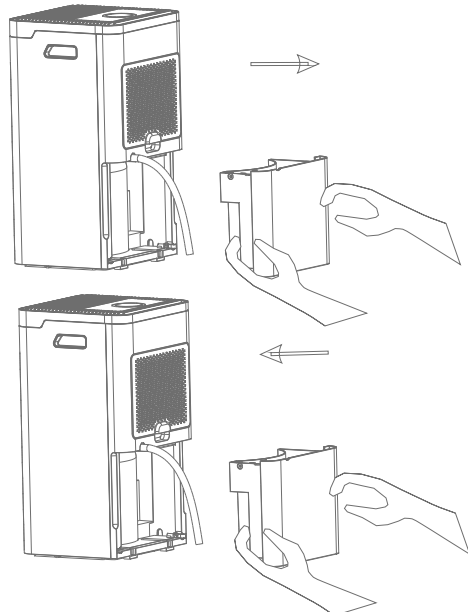

Cleaning and maintenance

▲WARNING: Before cleaning and maintenance, switch the appliance off and remove the plug from the socket, to prevent electric shock.

- ◆ Do not immerse any part of the appliance, power cord or plug in water or other liquids.
- ◆ Use only implements recommended by the manufacturer for defrosting or cleaning.
- ◆ Use a soft damp cloth to wipe the casing of the dehumidifier. Avoid using abrasive sponges and detergent, spray or chemicals as these may cause damage to the appliance.
- ◆ Use a soft dry cloth to wipe the control panel.
- ◆ Clean the water tank with soft cloth.
- ◆ Clean the filter at least once every two weeks.
- ◆ Empty and replace the water tank, clean the filter and unplug the dehumidifier if it is not to be used for a long time.

1. Remove the back cover from the unit and remove the filter.

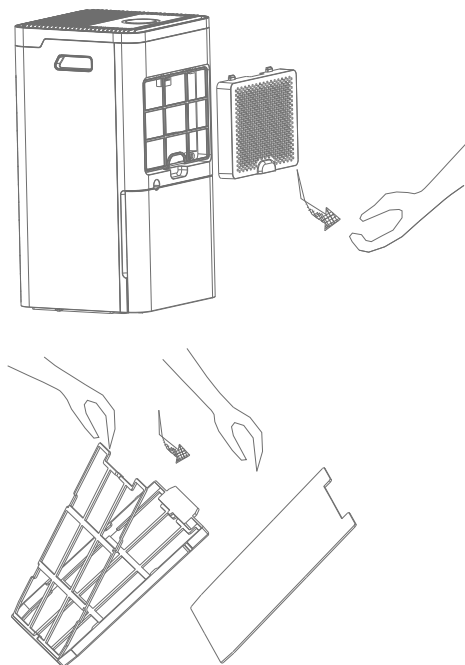

2. Use a vacuum cleaner or pat the filter lightly to dislodge the dust. If necessary wash the filter in water with a neutral detergent. Rinse well and leave to dry thoroughly.
3. Replace the filter into the back cover, ensuring the convex of the filter is upwards and the edges sit under the four clips.
4. Push the back cover up and back into the appliance until it clicks into place. The incorrect setting of the filter or cover will prevent the cover clicking into place.

If the appliance is not to be used for a long time:

- ◆ Unplug and the dehumidifier
- ◆ Empty, dry and replace the water tank
- ◆ Clean the air filter
- ◆ Store the unit upright in a cool, dry place, away from direct sunlight.

Storing The Unit

▲WARNING: Unplug the unit from the mains and ensure it has fully cooled down before storing.

Store in a cool, dry place, out of the reach of children.

Mains plug replacement

If a new mains plug needs to be fitted:

- ◆ Safely dispose of the old plug.
- ◆ Connect the brown lead to the live terminal in the new plug.
- ◆ Connect the blue lead to the neutral terminal.
- ◆ If the product is class I (earthed), connect the green/yellow lead to the earth terminal.

Note! If your product is class II double insulated (only 2 wires in the cord set), no connection is to be made to the earth terminal.

Follow the fitting instructions supplied with good quality plugs. Any replacement fuse must be of the same rating as the original fuse supplied with the product.

▲WARNING: The above section on mains plug replacement is for authorized service centre persons.

Before Initiation

To avoid damage, place the unit in an upright position for at least 24 hours before initiation. Make sure that the air outlet and air inlet are never blocked.

Only operate the unit on a horizontal surface to ensure no water leaks out.

▲WARNING:

- ◆ Do not exceed impedance greater than 0.236 Ohm in supply the appliance is connected to.
- ◆ Failure to comply may lead the supply authority to impose restrictions to connection.
- ◆ Please consult your energy supply authority if the use of equipment exceeds 0.236 ohm.
- ◆ When the portable air conditioner or dehumidifier is turned on, the fan can work continuously stable under normal conditions to provide the minimum air volume of 100m³/h even when the compressor is closed due to the temperature controller.

The following information is for qualified technicians ONLY to tend any problems with the BXEH6003GB

- ◆ **Please do not attempt to fix, repair or alter this product in any way unless you are fully qualified**
- ◆ **If you are concerned or want any further advice please call 0333 220 6089**

Instruction, Repairing Appliances Containing R290

1. Checks to the area prior to beginning work on systems containing flammable refrigerants, safety checks are necessary to ensure that the risk of ignition is minimised. For repair to the refrigerating system, the following precaution shall be completed prior to conducting work on the system.
2. Work procedure shall be undertaken under a controlled procedure so as to minimise the risk of a flammable gas or vapour being present while the work is being performed.
3. General work area - All maintenance staff and others working in the local area shall be instructed on the nature of work being carried out. Work in confined spaces shall be avoided.
4. Checking for presence of refrigerant - The area shall be checked with an appropriate refrigerant detector prior to and during work, to ensure the technician is aware of potentially toxic or flammable atmospheres. Ensure that the leak detection equipment being used is suitable for use with all applicable refrigerants, i.e. nonsparking, adequately sealed or intrinsically safe.
5. Presence of fire extinguisher - If any hot work is to be conducted on the refrigerating equipment or any associated parts, appropriate fire extinguishing equipment shall be available to hand. Have a dry powder or CO2 fire extinguisher adjacent to the charging area.
6. No ignition sources - No person carrying out work in relation to a refrigerating system which involves exposing any pipe work shall use any sources of ignition in such a manner that it may lead to the risk of fire or explosion. All possible ignition sources, including cigarette smoking, should be kept sufficiently far away from the site of installation, repairing, removing and disposal, during which refrigerant can possibly be released to the surrounding space.

Prior to work taking place, the area around the equipment is to be surveyed to make sure that there are no flammable hazards or ignition risks. "No Smoking" signs shall be displayed.

7. Ventilated area - Ensure that the area is in the open or that it is adequately ventilated before breaking into the system or conducting any hot work. A degree of ventilation shall continue during the period that the work is carried out. The ventilation should safely disperse any released refrigerant and preferably expel it externally into the atmosphere.
8. Checks to the refrigerating equipment - Where electrical components are being changed, they shall be fit for the purpose and to the correct specification. At all times the manufacturer's maintenance and service guidelines shall be followed. If in doubt, consult the manufacturer's technical department for assistance. The following checks shall be applied to installations using flammable refrigerants:
 - ◆ The actual refrigerant charge is in accordance with the room size within which the refrigerant containing parts are installed;
 - ◆ The ventilation machinery and outlets are operating adequately and are not obstructed;
 - ◆ If an indirect refrigerating circuit is being used, the secondary circuit shall be checked for the presence of refrigerant;
 - ◆ Marking to the equipment continues to be visible and legible. Markings and signs that are illegible shall be corrected;
 - ◆ Refrigerating pipe or components are installed in a position where they are unlikely to be exposed to any substance which may corrode refrigerant containing components, unless the components are constructed of materials which are inherently resistant to being corroded or are suitably protected against being so corroded.

9. Checks to electrical devices
 - ◆ Repair and maintenance to electrical components shall include initial safety checks and component inspection procedures. If a fault exists that could compromise safety, then no electrical supply shall be connected to the circuit until it is satisfactorily dealt with. If the fault cannot be corrected immediately but it is necessary to continue operation, an adequate temporary solution shall be used. This shall be reported to the owner of the equipment so all parties are advised. Initial safety checks shall include:
 - ◆ That capacitors are discharged: this shall be done in a safe manner to avoid possibility of sparking;
 - ◆ That no live electrical components and wiring are exposed while charging, recovering or purging the system;
 - ◆ That there is continuity of earth bonding.
10. Repairs to sealed components.
 - ◆ During repairs to sealed components, all electrical supplies shall be disconnected from the equipment being worked upon prior to any removal of sealed covers, etc. If it is absolutely necessary to have an electrical supply to equipment during servicing, then a permanently operating form of leak detection shall be located at the most critical point to warn of a potentially hazardous situation.
 - ◆ Particular attention shall be paid to the following to ensure that by working on electrical components, the casing is not altered in such a way that the level of protection is affected. This shall include damage to cables, excessive number of connections, terminals not made to original specification, damage to seals, incorrect fitting of glands, etc.
 - ◆ Ensure that the apparatus is mounted securely. Ensure that seals or sealing materials have not degraded to the point that they no longer serve the purpose of preventing the ingress of flammable atmospheres.
 - ◆ Replacement parts shall be in accordance with the manufacturer's specifications.
11. Repair to intrinsically safe components
 - ◆ Do not apply any permanent inductive or capacitance loads to the circuit without ensuring that this will not exceed the permissible voltage and current permitted for the equipment in use.
 - ◆ Intrinsically safe components are the only types that can be worked on while live in the presence of a flammable atmosphere. The test apparatus shall be at the correct rating.
 - ◆ Replace components only with parts specified by the manufacturer. Other parts may result in the ignition of refrigerant in the atmosphere from a leak.
12. Cabling
 - ◆ Check that cabling will not be subject to wear, corrosion, excessive pressure, vibration, sharp edges or any other adverse environmental effects. The check shall also take into account the effects of aging or continual vibration from sources such as compressors or fans.
13. Detection of flammable refrigerants
 - ◆ Under no circumstances shall potential sources of ignition be used in the searching for or detection of refrigerant leaks. A halide torch (or any other detector using a naked flame) shall not be used.
 - ◆ Removal and evacuation
 - ◆ When breaking into the refrigerant circuit to make repairs – or for any other purpose – conventional procedures shall be used. However, for flammable refrigerants it is important that best practice is followed since flammability is a consideration. The following procedure shall be adhered to:
 - ◆ Remove refrigerant;
 - ◆ Purge the circuit with inert gas;
 - ◆ Evacuate;
 - ◆ Purge with inert gas;
 - ◆ Open the circuit by cutting or brazing.
 - ◆ The refrigerant charge shall be recovered into the correct recovery cylinders. For appliances containing flammable refrigerants the system shall be purged with oxygen-free nitrogen to render the appliance safe for flammable refrigerants. This process may need to be repeated several times.

- ◆ Compressed air or oxygen shall not be used for purging refrigerant systems.
- ◆ For appliances containing flammable refrigerants, refrigerants purging shall be achieved by breaking the vacuum in the system with oxygen-free nitrogen and continuing to fill until the working pressure is achieved, then venting to atmosphere, and finally pulling down to a vacuum. This process shall be repeated until no refrigerant is within the system. When the final oxygen-free nitrogen charge is used, the system shall be vented down to atmospheric pressure to enable work to take place. This operation is absolutely vital if brazing operations on the pipe-work are to take place.
- ◆ Ensure that the outlet for the vacuum pump is not close to any potential ignition sources and that ventilation is available.
- ◆ Charging procedures

In addition to conventional charging procedures, the following requirements shall be followed.

- ◆ Ensure that contamination of different refrigerants does not occur when using charging equipment.
- ◆ Hoses or lines shall be as short as possible to minimise the amount of refrigerant contained in them.
- ◆ Cylinders shall be kept in an appropriate position according to the instructions.
- ◆ Ensure that the refrigerating system is earthed prior to charging the system with refrigerant.
- ◆ Label the system when charging is complete (if not already).
- ◆ Extreme care shall be taken not to overfill the refrigerating system.
- ◆ Prior to recharging the system, it shall be pressure-tested with the appropriate purging gas. The system shall be leak-tested on completion of charging but prior to commissioning. A follow up leak test shall be carried out prior to leaving the site.

14. Decommissioning

- ◆ Before carrying out this procedure, it is essential that the technician is completely familiar with the equipment and all its detail. It is recommended good practice that all refrigerants are recovered safely.
- ◆ Prior to the task being carried out, an oil and refrigerant sample shall be taken in case analysis is required prior to re-use of recovered refrigerant. It is essential that electrical power is available before the task is commenced.
 - a. Become familiar with the equipment and its operation.
 - b. Isolate system electrically.
 - c. Before attempting the procedure, ensure that:
 - ◆ Mechanical handling equipment is available, if required, for handling refrigerant cylinders;
 - ◆ All personal protective equipment is available and being used correctly;
 - ◆ The recovery process is supervised at all times by a competent person;
 - ◆ Recovery equipment and cylinders conform to the appropriate standards.
 - d. Pump down refrigerant system, if possible.
 - e. If a vacuum is not possible, make a manifold so that refrigerant can be removed from various parts of the system.
 - f. Make sure that cylinder is situated on the scales before recovery takes place.
 - g. Start the recovery machine and operate in accordance with instructions.
 - h. Do not overfill cylinders (no more than 80% volume liquid charge).
 - i. Do not exceed the maximum working pressure of the cylinder, even temporarily.
 - j. When the cylinders have been filled correctly and the process completed, make sure that the cylinders and the equipment are removed from site promptly and all isolation valves on the equipment are closed off.
 - k. Recovered refrigerant shall not be charged into another refrigerating system unless it has been cleaned and checked.

15. Labelling

- ◆ Equipment shall be labelled stating that it has been de-commissioned and emptied of refrigerant. The label shall be dated and signed. For appliances containing flammable refrigerants, ensure that there are labels on the equipment stating the equipment contains flammable refrigerant.

16. Recovery

- ◆ When removing refrigerant from a system, either for servicing or decommissioning, it is recommended good practice that all refrigerants are removed safely.
- ◆ When transferring refrigerant into cylinders, ensure that only appropriate refrigerant recovery cylinders are employed. Ensure that the correct number of cylinders for holding the total system charge is available. All cylinders to be used are designated for the recovered refrigerant and labelled for that refrigerant (i.e. special cylinders for the recovery of refrigerant). Cylinders shall be complete with pressure-relief valve and associated shut-off valves in good working order. Empty recovery cylinders are evacuated and, if possible, cooled before recovery occurs.
- ◆ The recovery equipment shall be in good working order with a set of instructions concerning the equipment that is at hand and shall be suitable for the recovery of all appropriate refrigerants including, when applicable, flammable refrigerants. In addition, a set of calibrated weighing scales shall be available and in good working order. Hoses shall be complete with leak-free disconnect couplings and in good condition. Before using the recovery machine, check that it is in satisfactory working order, has been properly maintained and that any associated electrical components are sealed to prevent ignition in the event of a refrigerant release. Consult manufacturer if in doubt.
- ◆ The recovered refrigerant shall be returned to the refrigerant supplier in the correct recovery cylinder, and the relevant waste transfer note arranged. Do not mix refrigerants in recovery units and especially not in cylinders.

If compressors or compressor oils are to be removed, ensure that they have been evacuated to an acceptable level to make certain that flammable refrigerant does not remain within the lubricant. The evacuation process shall be carried out prior to returning the compressor to the suppliers. Only electric heating to the compressor body shall be employed to accelerate this process. When oil is drained from a system, it shall be carried out safely.

Protecting the environment



Separate collection. Products and batteries marked with this symbol must not be disposed of with normal household waste.

Remember the environment when disposing of packaging around the appliance and when the appliance is no longer required.

Products and batteries contain materials that can be recovered or recycled, reducing demand for raw materials. Please recycle electrical products and batteries according to local provisions. Further information is available at www.2helpU.com.

Technical data

		BXEH60003GB
Input voltage	V AC	220 - 240
Frequency	Hz	50
Power input	W	210
Refrigerant R290	G	45
Degree of protection	IPX1	
Permissible operational pressure (High/Low)	Mpa	1.2
Maximum allowable pressure (High/Low)	Mpa	2.5
Noise	dB (A)	42
Weight	KG	10
Extraction	Litres/Day	20
Water tank	Litres	2.5
Size	L x W x H (mm)	250 x 250 x 460

Product Guarantee

This product comes with a 2 Year guarantee from the original date of purchase. If any defect arises due to faulty materials of workmanship, the faulty products must be returned to the place of purchase. Refund or replacement is at the discretion of the retailer. This guarantee is in addition to and in no way prejudices your statutory rights.

The Following Conditions Apply:

- ◆ The product must be returned to the retailer with proof of purchase or a receipt within the 1st year of purchase. For any product related issues after 12 months please contact our customer services team.
- ◆ The product must be installed and used in accordance with the instructions contained in this instruction guide.
- ◆ It must be used only for domestic purposes.
- ◆ It does not cover wear and tear, damage, misuse or consumable parts.
- ◆ This guarantee is valid in the UK and Republic of Ireland.

For all customer service enquires please contact us below;

RKW,

Sutton House,

Berry Hill Road,

Stoke-on-Trent,

ST4 2NL

Email blackanddecker@rkwltd.com

Tel 0333 220 6089

Black & Decker® and BLACK+DECKER™ and the Black & Decker® and BLACK+DECKER™ logos are registered trademarks of The Black & Decker® Corporation and are used under licence. All rights reserved. Imported and Distributed by RKW LTD, Sutton House, Berry Hill Industrial Estate, Berry Hill Road, Stoke-on-Trent, ST4 2NL

