

COLZER Dehumidifier User Manual

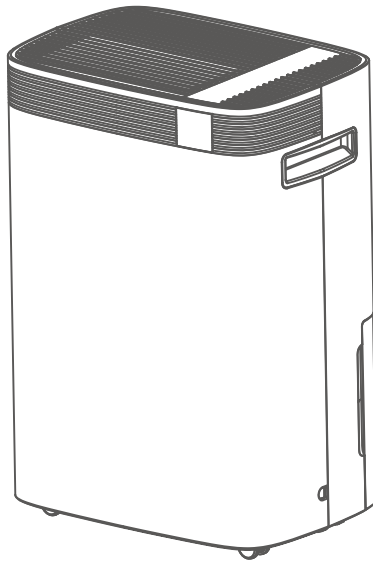

Model No.:HD10C

Please read this user manual before operating and save for future reference.

Welcome

Thanks for choosing COLZER dehumidifier!

COLZER is dedicated to keeping people healthy, comfortable and more enjoyable by offering quality appliances range from dehumidifiers, air purifiers, humidifiers to refrigerators, wine coolers, ice makers, and more. From breathing easier in your office to upgrading your kitchen appliances, we hope COLZER could help you every step of the way.

We do hope you'll enjoy the dehumidifier you purchased from us.

Before plugging in your new dehumidifier, we suggest that you read this user manual as it contains important safety information, operation instructions, troubleshooting, maintenance tips, and warranty information to ensure the reliability and longevity of your dehumidifier.

We also kindly ask you to take a few minutes to register your product at

<https://colzer.com/pages/join-vip> for more efficient support. Although greatly appreciated, product registration is not required to activate any warranty.

It is our goal that you are always happy with what you bought from us, so please let us know if your buying experience was anything short of excellent.

We're always just an email away

To access customer support, please email to service@colzer.com with your purchase order ID to help us address the problem faster and serve you better.

Thank you again!

BEFORE FIRST USE:

Please leave the dehumidifier standing upright and outside the box for **24 HOURS** before plugging it in.

The dehumidifiers may have been tilted or placed upside down during shipping. Leave the dehumidifier to stand upright for 24 hours so the oil in the compressor can settle from the move, not doing so can affect the performance or lifespan of the dehumidifier.

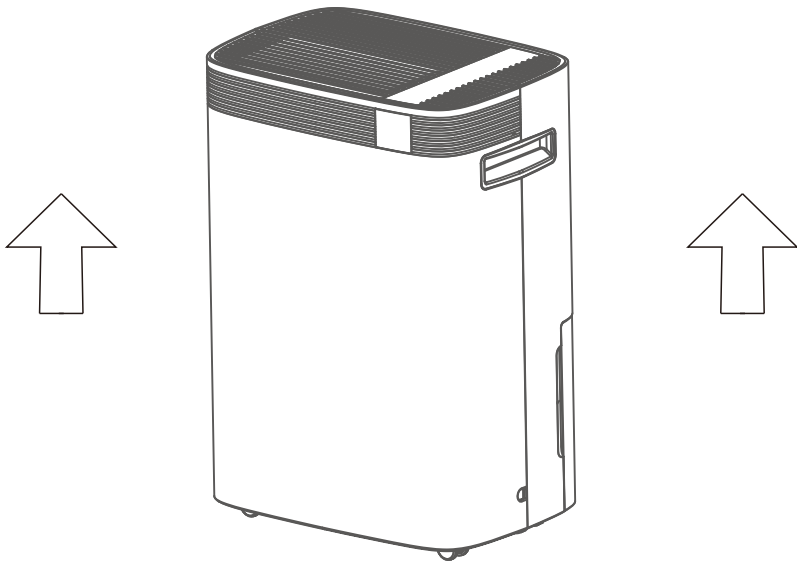

CONTENTS

SAFETY INFORMATION	1
PARTS IDENTIFICATION	2
OPERATION INSTRUCTIONS	3
1. Position Your Dehumidifier	3
2. Plug in	3
3. Turn the Dehumidifier On	3
4. Understand the Control Panel	4
5. Select Proper Mode	5
6. Speed Setting	6
7. Timer Setting	7
8. CHILD LOCK.....	7
9. Drain Collected Water	8
10. Smart Functions	10
MAINTENANCE	11
1. Clean the Vent and Housing.....	11
2. Clean the bucket	11
3. Clean the Air Filter	11
4. When Not Using dehumidifier for Long Periods of Time	12
SPECIFICATION	13
TROUBLE SHOOTING	14
1. Error Codes	14
2. Trouble Shooting	14

SAFETY INFORMATION

To prevent injury and property damage, the following instructions must be followed when using the dehumidifier.

1. Install the dehumidifier properly on a floor, table, or shelf that is level and strong enough to support it when the water bucket is full.
2. Do not place the dehumidifier near a heater.
3. Do not use the dehumidifier near flammable gas or combustibles, such as gasoline, benzene, thinner, etc.
4. Always plug into a grounded outlet properly.
5. Do not use if the power cord is broken or damaged.
6. Do not use the socket if it is loose or damaged.
7. Do not place a heavy object on the power cord and make sure that the cord is not compressed.
8. Do not modify power cord length.
9. Do not operate the dehumidifier with wet hands.
10. Do not place flower vases or other water containers on top of the dehumidifier.
11. Do not climb on or sit on the dehumidifier.
12. Do not operate or turn off the dehumidifier by plugging in or unplugging the dehumidifier. Use the control panel instead.
13. Disconnect the power if strange sounds, odors, or smoke come from the dehumidifier.
14. Hold the plug by the head when taking it out.
15. Make sure to turn off and unplug the dehumidifier before cleaning.
16. Use a soft cloth to clean. Do not use wax, thinner, or a strong detergent.
17. Do not clean the dehumidifier with water. If water enters the dehumidifier, turn off the dehumidifier immediately.
18. Care should be taken when using the dehumidifier in a room with the following persons: infants, children, the elderly and people not sensitive to humidity.
19. Never insert your finger or other foreign objects into grills or openings. Take special care to warn children of these dangers.
20. Turn off and disconnect the power when not using the dehumidifier for a long time.

PARTS IDENTIFICATION

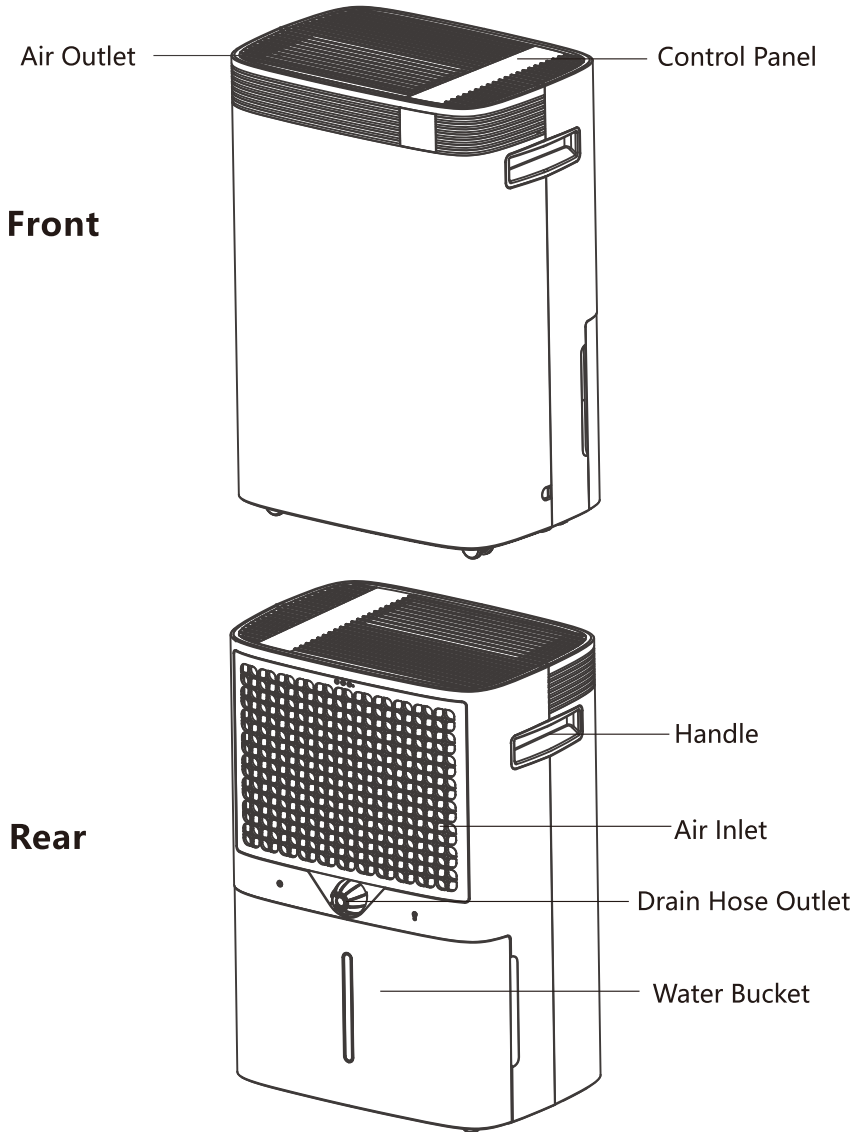

NOTE: DO NOT OBSTRUCT THE AIR INLET AND/OR OUTLET.

OPERATION INSTRUCTIONS

1. Position Your Dehumidifier

- Place the dehumidifier on a smooth, level floor that is strong enough to support the dehumidifier with a full bucket of water.
- To maintain efficiency, operate the dehumidifier in an enclosed area. Keep nearby doors and windows closed.
- Maintain a minimum clearance of 20 cm (7.9 inches) on the sides and back of the dehumidifier and 40 cm (16 inches) on the top of the dehumidifier to allow for proper air circulation.
- To use the dehumidifier to dry wet clothes, maintain a minimum clearance of 40 cm (16 inches) to the air outlet of the dehumidifier to avoid water dripping into the dehumidifier.
- The functioning temperature range is between 5°C (41°F) and 35°C (95°F).

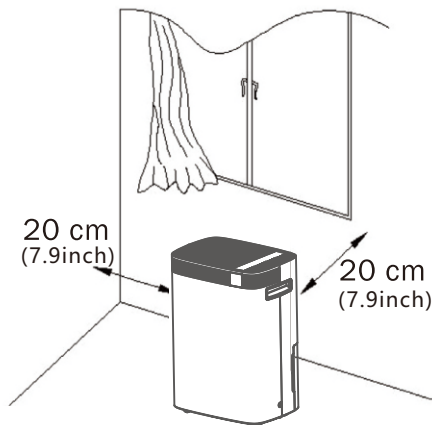

2. Plug in

IMPORTANT

Please let the dehumidifier stand upright box for **24 hours** before initial plugging in.

Uncoil the power cord and plug it firmly into a properly grounded 110-120 volt AC outlet. After plugged in, the control panel will light up for 1-2 seconds and then goes off, which is the normal self-diagnose process and does not require any user intervention.

3. Turn the Dehumidifier On

Press the **POWER** button to turn the dehumidifier on. Typically, the dehumidifier will run in the default setting with set humidity 30% at low fan speed in the normal DEHUMIDIFY(DEHU) mode.

NOTE: : If the dehumidifier does not run automatically and you see the "FULL" icon illuminate, please remove the water bucket and re-install it properly

4. Understand the Control Panel

This dehumidifier features a control panel with LED on the top and a digital display on the front. The front display displays the same content, like humidity readout or error codes, as the digital display on the top control panel. So you can read the room humidity level on the front display easily, in a visible distance.

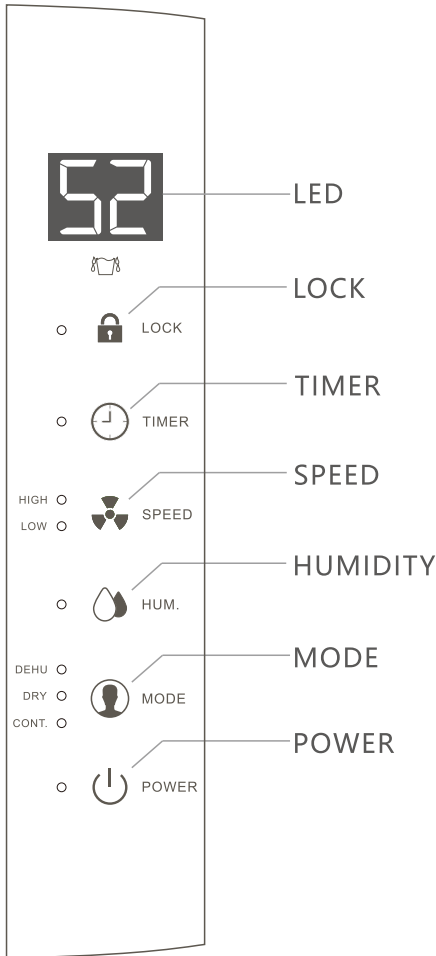

POWER Button

To turn the dehumidifier ON/OFF.



MODE Button

To select working mode between DEHU, DRY, CONT.



LOCK Button

To lock/unlock the Control Panel.



HUM. Button

To set target humidity value.(30%-80%)



TIMER Button

To set Auto ON/OFF timer in 1-24 hrs.



SPEED Button

To select fan speed between high and low.



WATER FULL Icon

Indicates the water bucket is full.

5. Select Proper Mode

Press the MODE button to switch the working mode between DEHU (DEHUMIDIFY) mode, DRY (Drying) mode, and CONT (Continuous) mode. The corresponding indicator will illuminate when that mode has been selected.

- DEHU Mode:** HUM. Button and SPEED button are available to use.
- DRY Mode:** Both HUM. Button and SPEED button are disabled.
- CONT Mode:** HUM. Button is disabled. SPEED button is available to use.

(1) DEHU (DEHUMIDIFY) Mode

In the DEHU (DEHUMIDIFY) mode, the dehumidifier will automatically stop and restart based on the humidity setting, which is called Humidstat Mode, hence maintaining the room humidity within the range of $\pm 3\%$ of the set point.

For example, the set humidity is 50%, the dehumidifier will automatically stop working when the room humidity reaches 47%, and then automatically restart when the room humidity raises up to 53%.

NOTE:

- When the set humidity level is not at least 3% lower than the room humidity level, the dehumidifier won't start.
- When the room humidity level has been dropped down to the set-point, the dehumidifier will auto stop dehumidifying and the LED will flash.
- If you set the target humidity at 30%, the dehumidifier will run continuously until the water bucket is full.

To run the dehumidifier in the normal DEHUMIDIFY mode:

- Select DEHU (DEHUMIDIFY) Mode:** Press the MODE button until you see the "DEHU" indicator light up on the display.
- Check the Room Humidity:** Typically, the digital number on the display is the humidity readout of the inlet air, which is similar to the room humidity level
- Set Your Desired Humidity**
 - ① After selecting DEHU (DEHUMIDIFY) mode, press the HUM. button once, the digital number on the LED will turn to display the previous humidity set-point and flash.
 - ② Press the HUM. button repeatedly to adjust the set-point of humidity level between 30%-80% in 5% increments.

- ③ After you have selected the desired value, please wait for 5 seconds until the digital number stops flashing, during which time the setting will be automatically registered.

Note: The set humidity value needs to be at least 5% lower than the room humidity level.

•**Let the Dehumidifier Run:** The dehumidifier will automatically stop when the room humidity reaches the target Humidity value or when the water bucket is full.

(2) DRY (Laundry Dry) Mode

Press the MODE button until you see the “DRY” indicator light up on the display to select DRY-CLOTHES mode. In the DRY mode, the dehumidifier will run continuously at high fan speed.

Note: In the DRY mode, the HUM. button and SPEED button disabled

To Use the DRY Mode to Dry Wet Garments

- Hang the clothes in a small room;
- Position the dehumidifier properly (maintain a minimum clearance of 40 cm (16 inches) to the air outlet of the dehumidifier to avoid water dripping into the dehumidifier);
- Close the windows and doors;
- Run the dehumidifier in the DRY mode.

(3) CONT (Continuous) Mode

Press the MODE button until you see the “CONT” indicator light up on the display to select continuous mode. In the CONT mode, the dehumidifier will run continuously until the water bucket is full.

Note: In the CONT mode, the HUM. button is disabled. SPEED button is available for setting.

6. Speed Setting

Press the SPEED button to change the fan speed to HIGH or LOW. When the fan speed was set to high, the “HIGH” indicator will light up. When the fan speed was set to low, the “LOW” indicator will light up. High fan speed will result in quicker moisture removal, while low fan speed for quiet operation.

7. Timer Setting

The TIMER function enables you to either delay AUTO-ON or delay AUTO-OFF the dehumidifier in the choice from 1 hour to 24 hours.

- **Setting an AUTO-ON timer:** When the dehumidifier is off, selecting Timer will turn the dehumidifier on in the hours that will be set.
- **Setting an AUTO-OFF timer:** When the dehumidifier is on, selecting Timer will turn the dehumidifier off in the hours that will be set.

Follow the below steps to set the TIMER:

- 1) Press the TIMER button once, the timer indicator will light up and the digital number will turn to display as **00** and flash;
- 2) Adjust the timer setting by pressing the TIMER button repeatedly to change the delay timer at 1-hour increments, up to 24 hours;
- 3) After selecting the target timer value, wait for 5 seconds to let the setting be registered automatically and the digital number turns to be the room humidity readout;
- 4) The control will count down the time remaining (8,7,6, etc.) until the dehumidifier either ON or OFF.
- 5) When the timer function is enabled, the timer indicator will light up and you can check the time remaining by pressing the TIMER button once.

Note:

- Before entering AUTO ON timer setting, make sure power is being supplied to the dehumidifier and turn on the dehumidifier to set a target humidity level first. Otherwise, the humidity maintained will be the same as the previous setting.
- You can only set AUTO ON timer when the dehumidifier is off or set AUTO OFF timer when the dehumidifier is on, but you will not be able to set both AUTO ON and AUTO OFF timer at the same time.
- The TIMER will ONLY function one time instead of cycling the dehumidifier on or off indefinitely.
- To disable the timer, manually turn on/off the dehumidifier or set the timer at 00.

8. LOCK

Press and hold the LOCK button for 3-5 seconds to lock or unlock the control panel.

When the LOCK function has been activated, the indicator illuminates, and other buttons will be disabled. To regain use of the buttons, unlock the control button.

9. Drain Collected Water

(1) Emptying the Water Bucket

When the bucket is full, the dehumidifier will automatically stop working and make a beep sound for 5 seconds. Meanwhile, the LED will display an E7 error message and the Water FULL icon will illuminate. Do not move the dehumidifier at this time in case the water spills on the floor.

To remove the bucket to empty the collected water:

- Gently remove the water bucket from the dehumidifier;
- Empty the bucket;
- Replace the water bucket in the dehumidifier. The dehumidifier will auto eliminate the E7 error and resume operation in 1-3 minutes after the water bucket been replaced properly

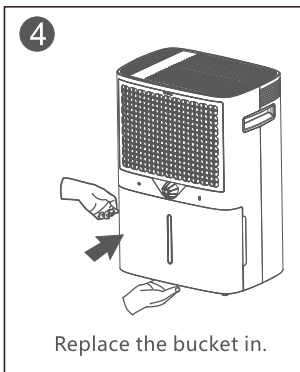
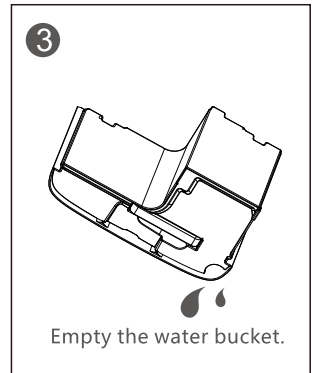
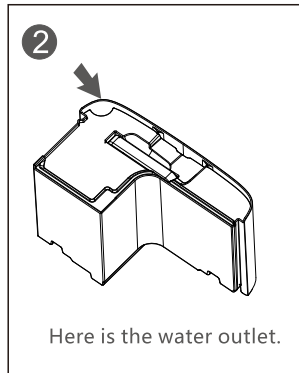
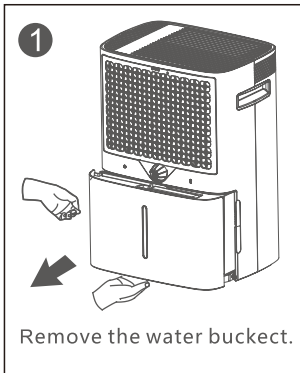

(2) Continuous Drain by Gravity

Water can be automatically be emptied into a floor drain by attaching the included drain hose.

To Achieve Continuous Drain by Gravity:

- Remove the drain outlet cover;
- Find the continuous drain outlet as illustrated;
- Pull out the black stopper;
- Attach one end of the drain hose to the drain outlet;
- Direct the other end of the drain hose down to a suitable drainage facility, like a floor drain.

The drainage facility should be lower than the drain outlet of the dehumidifier.

Note:

- Make sure the connection is tight and there is no leaking.
- Be sure to run the water hose sloping downward to let the water flow out smoothly. No kinks or bent.
- To improve gravity draining, you can raise the dehumidifier onto another higher and flat surface, like a table.
- If the condensation water would be drained out to an external container via the hose, be sure NOT to submerge the other end of the hose into the drained out water.
- It is recommended to use a short hose. If the drain hose is too long, water may not drain completely, which can lead to stagnant water and mildew build up inside the hose.
- When the continuous drain feature is not being used, remove the drain hose from the outlet and put the drain outlet cover on.

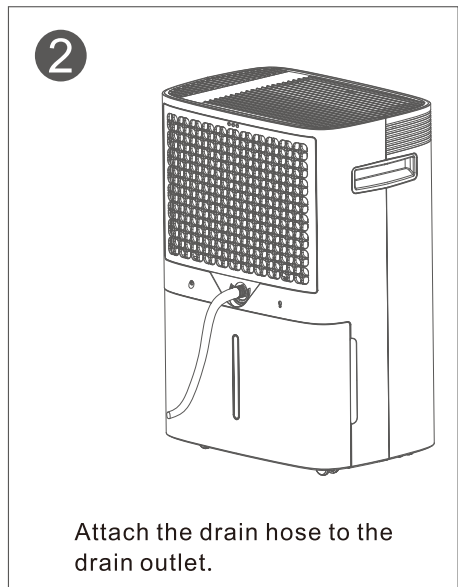
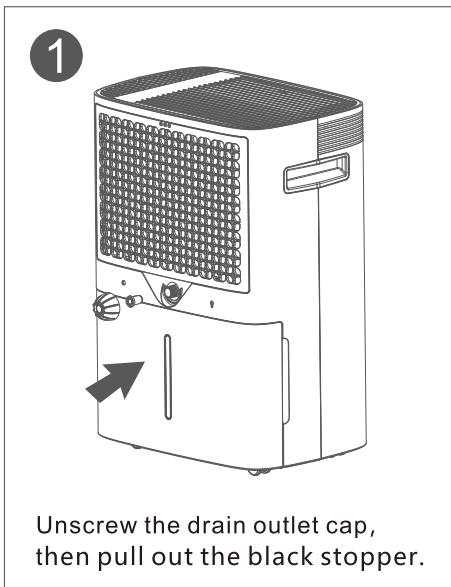

10. Smart Functions

(1) Auto Shut Off

When the bucket is full and/or the room humidity reaches the set point, the dehumidifier will stop working automatically.

- When the water bucket is full, the LED will display an E7 code, the WATER FULL icon will illuminate and the dehumidifier will make a beep sound for a few seconds. In this case, empty the water bucket and replace the water bucket to resume operation.
- When the room humidity is down to the set-point, the LED display will flash. In this case, you can turn the dehumidifier off or just let it stay in standby mode so it can automatically restart when the room humidity raises back.

(2) Wait 3 Minutes before Resuming Operation

To avoid any damage to the dehumidifier, the compressor will not start operation following a complete cycle until after 3 minutes. The operation will automatically start after 3 minutes.

For example, when the dehumidifier has been turned on immediately after being turned off, the compressor won't start until 3 minutes later. During the 3-minutes delay start time, you can POWER indicator flashing which means the compressor does not kick in. When the compressor kicks in, you can feel the dehumidifier shakes a little and the POWER indicator turns to statically illuminate.

(3) Auto Defrost

When the frost builds up on the evaporator coils, the compressor will cycle off and the fan will continue to run until the frost disappears. During defrost process, the POWER indicator will flash.

(4) Auto-Restart

If the dehumidifier shuts off unexpectedly due to power being cut while it is running or in standby mode, the dehumidifier will restart with the previous function setting (working mode, set humidity, fan speed and etc.) automatically when the power resumes.

MAINTENANCE



To avoid possible electric shock, ensure to turn the dehumidifier off and disconnect the plug from the power source before performing any cleaning or maintenance.

1. Clean the Vent and Housing

- Use water and mild detergent. Do not use bleach or abrasives.
- Do not splash water directly onto the main dehumidifier. Doing so may cause an electric shock or the insulation to deteriorate, or cause the dehumidifier to rust.
- The air intake and outlet vents get soiled easily, so use a vacuum attachment or brush to clean.

2. Clean the Water Bucket

Every few weeks, clean the water bucket to prevent the growth of mold, mildew, and bacteria.

Follow the below steps to open the water bucket correctly to clean:

- Take out the water bucket;
- Remove the cover of the water bucket;
- Partially fill the water bucket with clean water and add a little mild detergent;
- Swish it around in the water bucket, empty and rinse.

NOTE: Do not clean the water bucket in a dishwasher.

3. Clean the Air Filter

The air filter is located behind the rear intake grill to prevent dust coming into the dehumidifier.

The filter should be cleaned approximately every 2 weeks and may require more frequent cleaning if there is significant dander or fur in the air.

Follow the steps below to clean the filter:

- Take the grill on the back of the dehumidifier out. The filter is attached behind the grill.
- Use a vacuum cleaner with a soft brush attachment to remove any large debris or dust build-up from the filter.
- Wash the filter in lukewarm, soapy water, below 40°C (104°F), or use a neutral cleaning agent.
- Rinse the filter with clean water and dry thoroughly.
- Re-install the filter.

NOTE: DO NOT operate the dehumidifier without a filter because dirt and lint will clog it, hence reducing performance.

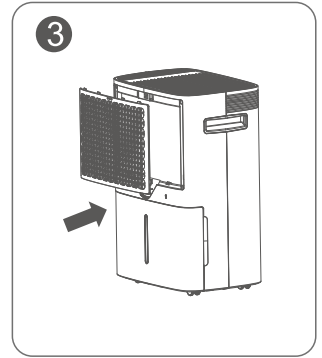
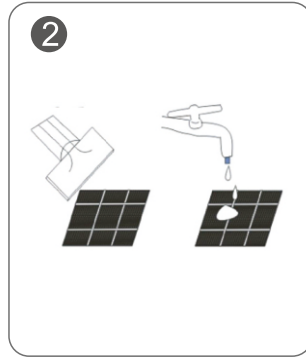
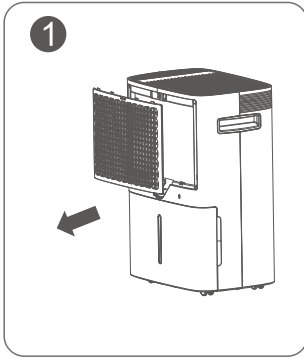

4. When Not Using Dehumidifier for Long Periods of Time

- Operate the dehumidifier on high fan mode for half a day, and then wait 1 day before emptying the bucket.
- Clean the housing and vents, water bucket, and air filter. Ensure the whole dehumidifier is clean and dry.
- Wrap the cord and drain pipe and bundle them to keep safe.
- Cover the dehumidifier with a plastic bag.
- Store the dehumidifier upright in a dry, well-ventilated place.

SPECIFICATION

MODEL	HD10C
POWER SOURCE	120V ~ 60Hz
RATED POWER (95 °F,90%RH)	720W
RATED CURRENT(95 °F,90%RH)	6.5A
MOISTURE REMOVAL CAPACITY(65 °F,60%RH)	35 Pints/Day
MOISTURE REMOVAL(80 °F,60%RH)	50 Pints/Day
MOISTURE REMOVAL(86 °F,80%RH)	80 Pints/Day
MOISTURE REMOVAL(95 °F,90%RH)	100 Pints/Day
INPUT POWER(65°F,60%RH)	380W
INPUT CURRENT(65°F,60%RH)	3.6A
IEF(65 °F,60%RH)	1.80 liters/kWh
MOTOR FLA	0.5A
MOTOR COMPRESSOR	RLA:7.0A LRA:19A
REFRIGERANT	R410A/6.0oz(170g)
MAXIMUM ALLOWABLE PRESSURE	800PSIG(5.5MPa)
HIGH PRESSURE	580PSIG(4.0MPa)
LOW PRESSURE	247PSIG(1.7MPa)
Water Bucket Capacity	5L

TROUBLE SHOOTING

1. Error Codes

Error Code	Problem	Solution
E1	Humidity Sensor Malfunction	1. Check the humidity sensor and ensure it is in good condition. 2. Replace the humidity sensor.
E2	Defrost Temperature Sensor Malfunction	1. Check the temperature sensor and ensure it is in good condition. 2. Replace the temperature sensor.
E4	Inlet Temperature Sensor Malfunction	1. Check the temperature sensor and ensure it is in good condition. 2. Replace the humidity sensor.
E7	Water bucket is full.	Empty the water bucket.
	The water bucket has not been installed properly.	Re-install the water bucket properly.
	Float Malfunction	Replace the float of the water bucket.

When E1, E2, or E4 error displays, you can hear an alarm that could last 15 seconds. In this case, the dehumidifier is still running. You can follow the below steps to eliminate the error message:

- Pressing any button on the control panel to eliminate the alarm.
- Turn off the dehumidifier and unplug it to check if any obstructions.
- Restart the dehumidifier 10 minutes later.

If the ERROR message does not disappear after the restart, immediately contact COLZER customer service at service@colzer.com.

2. Trouble Shooting

The below chart will help you solve common problems that may occur. If the problem you come across can not be fixed after troubleshooting or the problem is not listed in the below troubleshooting chart, please contact COLZER customer service to obtain professional support.

Problem	Possible Causes	Solutions
Dehumidifier can not turn on	The power cord is unplugged.	Plug it in.
	The fuse is blown or circuit breaker is tripped.	Check the fuse or the circuit breaker.
Dehumidifier is on, but it does not run.	The water bucket is full or not in the proper position.	Make sure the water bucket is empty and has been installed properly.
	The room humidity has reached the set-point. The DEHU icon flashes.	Set a lower humidity or let the dehumidifier keep in standby mode so it can auto ON when the room humidity level raises up.
	The room humidity is lower than the set humidity. The DEHU icon flashes.	The set humidity needs to be at least 5% (recommend 10%) lower than room humidity.
	The dehumidifier is in the defrosting process.	It is normal the compressor ceases during the defrosting process.
Insufficient Performance	Insufficient dehumidifying time.	When first installed, allow at least 3-4 days to maintain the desi red RH.
	The room has not been sealed properly.	Ensure that all doors, windows and other openings are closed.
	The air filter is dirty.	Clean the air filter.
	Airflow has been blocked.	Ensure there are no obstructions block the airflow.
	There is something giving off water vapor in the room.	Remove those items or turn off such devices that give off vapor in the room.
	The room temperature is low.	Heat up the room.
Dehumidifier operates continuously	The dehumidifier size is too small for the room.	Increase the quantity of dehumidifiers. Or change a higher capacity dehumidifier.
	Check if the dehumidifier is in CONTINOUS MODE.	Don't set the humidity too low. Typically, 40-50% are good settings to use.
	The room humidity is too high.	Change humidity settings. Or change a higher capacity dehumidifier.
Noise	Doors and windows are open.	Ensure that all doors, windows and other openings are closed.
	The dehumidifier 's not positioned level.	Position the dehumidifier on a level surface.
	The water bucket is not in the proper position.	Re-install the water bucket properly.
Frost appears on the coils	The air filter is clogged.	Wash the filter.
	The dehumidifier has been turned on recently.	This is normal frost builds up on the coils, especially when the room temperature is low. The dehumidifier will defrost automatically.
Room temperature is close to or lower than 60°F.		
Water leakage	Hose connection is loose.	Check the hose connection. Try to attach the other end of the hose to the outlet.
Water does not drain from the hose	Hose connection is loose.	Check the hose connection. Try to attach the other end of the hose to the outlet.
	Water flow has been restricted.	Hoses more than 7 feet long may not drain properly. It is recommended to keep the hose as short as possible. The hose must be placed lower than the bottom of the dehumidifier, and be kept flat and smooth without kinks.

