

Dehumidifier Déhumidificateur Dehumidificador

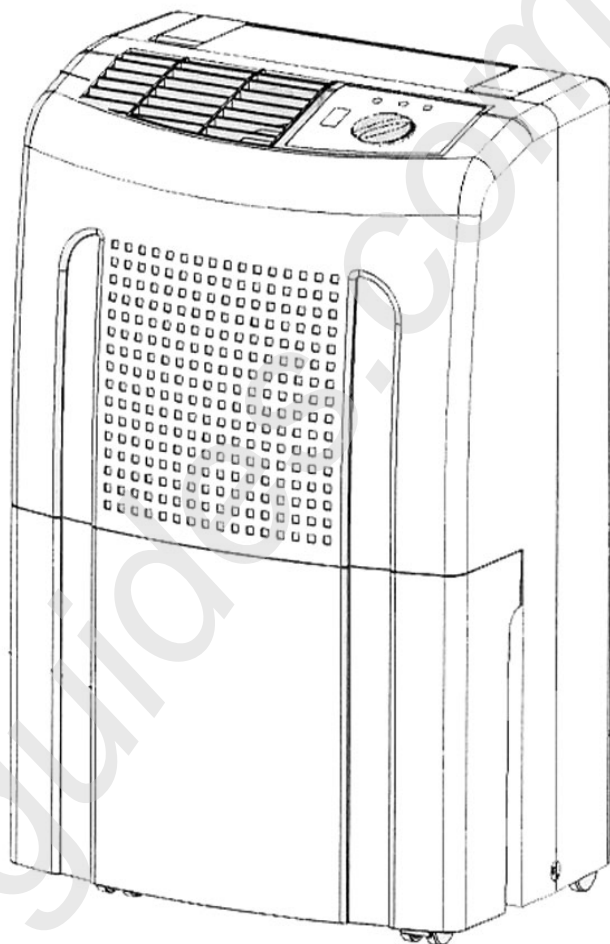

User Manual
HDN305/HDN455/HDN655

Guide de l'Utilisateur
HDN305/HDN455/HDN655

Manual del Usuario
HDN305/HDN455/HDN655

Before operating this dehumidifier, please read these instructions completely.

Haier
•••••

Quality ■ Innovation ■ Style

Table Of Contents

	page
Safety Precautions	1
Important Safety Information	3
Features Diagram	4
Part Names	4
Control Panel.....	5
Operation	5
Specifications	6
Operation Instructions	6
Start Operation	6
When Tank is Full	6
Continuous Drainage	7
Installing Drainage PVC Hose	7
Caution	8
Maintenance/Emergency	8
Troubleshooting	9
Warranty Information.....	10

Important Safety Information

READ ALL SAFETY INFORMATION BEFORE USING

When using this dehumidifier, always follow basic precaution including the following:

- This dehumidifier must be properly installed and grounded as described in this manual.
- Never operate this dehumidifier in an area that is likely to accumulate standing water. If this condition develops, disconnect the power supply before stepping into the water.
- Do not operate dehumidifier in presence of explosive fumes.
- Repair or replace immediately all electric service cords that have become frayed or otherwise damaged. Do not use a power cord that shows signs of damage along its length, on the plug, or where it is connected to the appliance.

SAVE THESE INSTRUCTIONS

Thank you for using our Haier product. This easy-to-use manual will guide you in getting the best use of your dehumidifier. Remember to record the model and serial number. They are on a label in back of the dehumidifier.

Staple your receipt to your manual. You will need it to obtain warranty service.

Model number

Serial number

Date of purchase

Before Using your Dehumidifier

Read this manual carefully. It contains instructions to help you use, maintain and enjoy your dehumidifier.

UNPACK YOUR DEHUMIDIFIER

- Remove all packing material. This includes foam, inserts & adhesive tape.
- Inspect any remains of packing, tape or printed material, or accessories before discarding it.

ELECTRICAL REQUIREMENT

- Make sure there is a suitable power outlet (115Volts 15 Amps) with proper grounding.

GROUNDING

- This dehumidifier must be grounded.
- Grounding reduces the risk of electric shock by providing an escape wire for the electric current.
- The power cord has a grounding plug. Plug it in to an outlet that is properly installed and grounded.

Warning- Improper use of the grounding plug can result in a risk of electric shock. Call a qualified electrician if you don't understand the grounding instructions or if you are not sure if the humidifier is properly grounded. If the wall outlet is not grounded, please contact an electrician to have it replaced with a properly grounded outlet.

Do not, under any circumstances, cut or remove the third (ground) prong from the power cord.

USE OF EXTENSION CORD

- Avoid the use of extension cord because of potential safety hazards under certain condition.
- If it is necessary to use an extension cord, use:
 - A) Only 3-wire extension cord that has 3-blade grounding plug and grounded wall outlet that will accept the plug.
 - B) The mark rating of the extension cord must be equal or greater than the electrical rating of the dehumidifier.

Features Diagram

PART NAMES

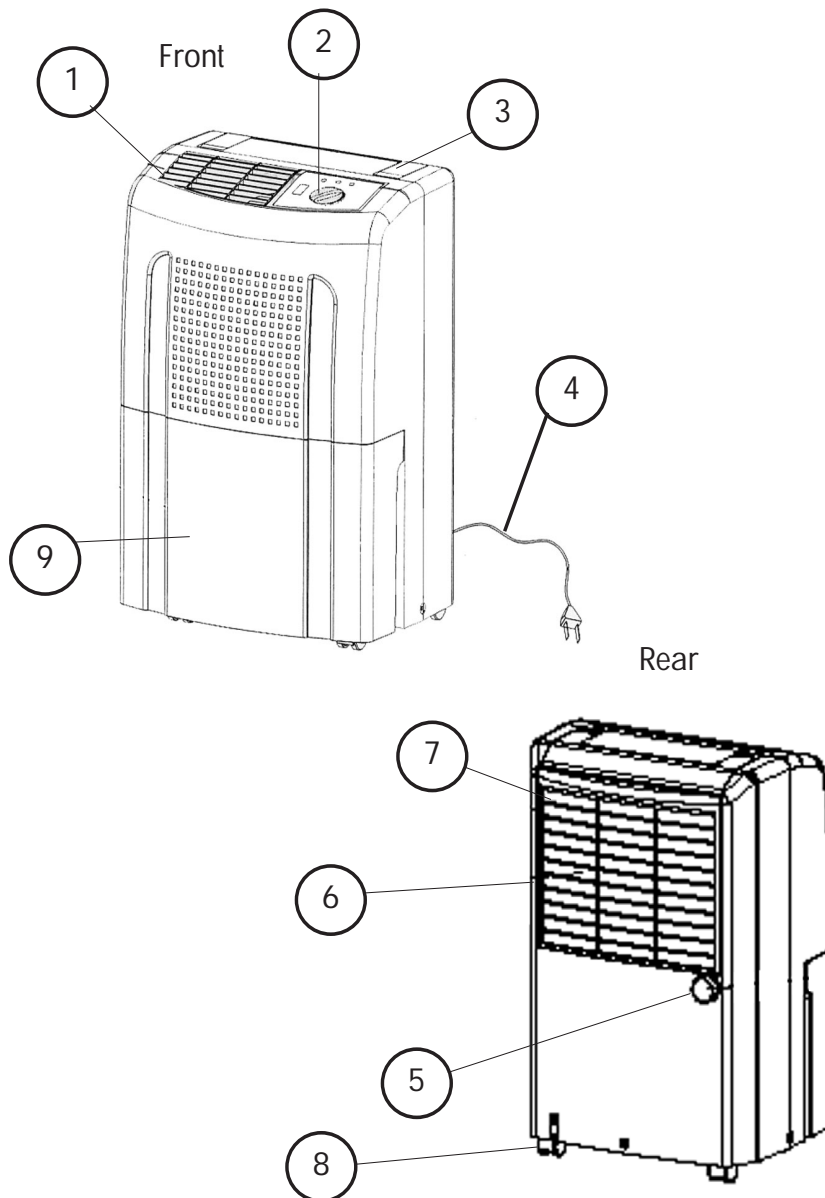

- | | |
|---------------------------------------------------------------|---------------------|
| 1. Dehumidified Dry Air Vent | 6. Moist Air Intake |
| 2. Control Panel | 7. Air Filter |
| 3. Handle | 8. Rotating Wheels |
| 4. Power Supply Cord | 9. Drainage Bucket |
| 5. Continuous Drainage Outlet
(Capped for bucket drainage) | |

CONTROL PANEL

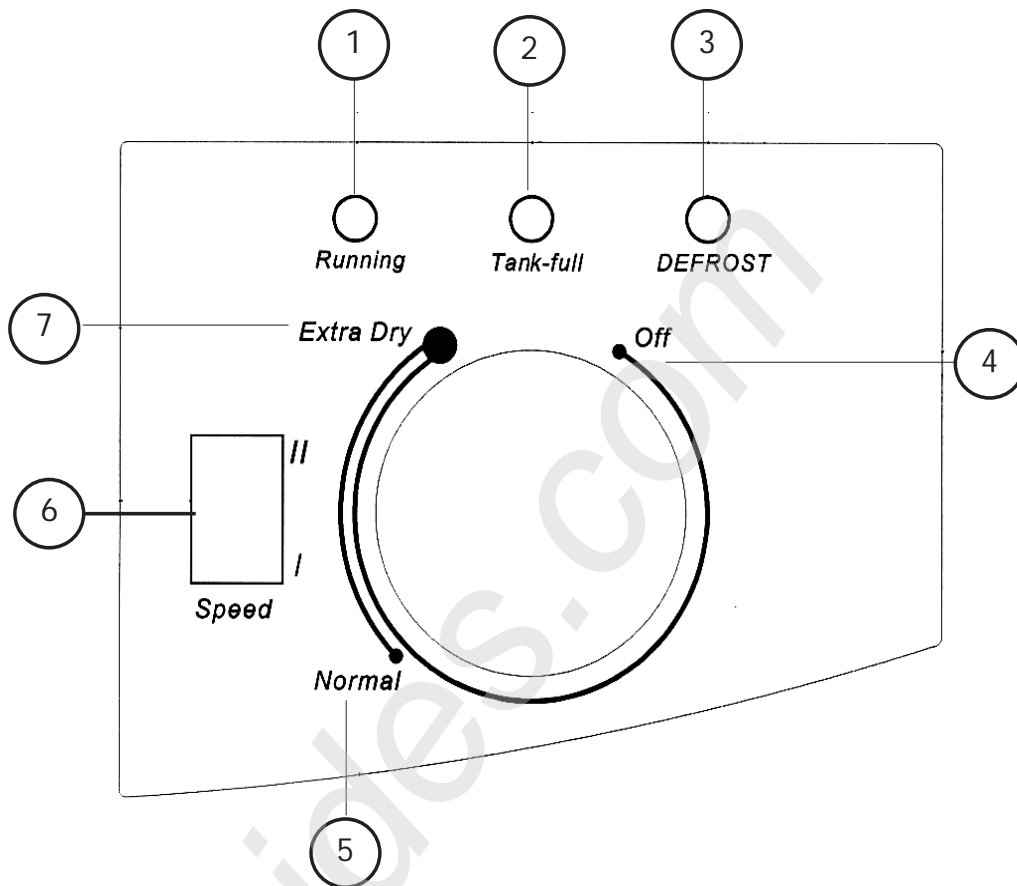

1. **Running Lamp**
The lamp lights up which means dehumidifier is operating.
2. **Full Tank Light**
When water tank is full, the Full Tank Light will light up and the dehumidifier will stop operating automatically.
3. **Defrost Light**
When operating under low temperature conditions, automatic defrost may activate. Light indicates that the unit is currently in defrost mode.
4. **Off**
Dehumidifier stop removing moisture.
5. **Normal**
Humidity control between 50%-60%.
6. **Fan Speed Control**
7. **Extra Dry**
Dehumidifier continuously removing moisture.

OPERATION

1. Turn the knob clockwise to begin unit operation. Turn it to "Off" again to stop the operation.
2. Turn the knob clockwise to increase the humidity setting and counter-clockwise to decrease the humidity setting.
3. Press "Speed" button to select high (H) or low (L) speeds.

Specification

Model	HDN305	HDN455	HDN655
Power	AC 115V/60 Hz		
Moisture Removal	30 Pint/D (80°F/27°C 60%RH)	45 Pint/D (80°F/27°C 60%RH)	65 Pint/D (80°F/27°C 60%RH)
Power Input	500 W	600 W	780 W
Size of Shell (H x W x D)	23-1/32" x 14-31/32" x 12-19/32" (585 x 380 x 320 mm)		
Weight	35.3 lbs./16 kgs.	35.3 lbs./16 kgs.	38.6 lbs./17.5 kgs.
Operating Temperature	41°F-95°F (5°C ~ 35°C)		

Operating Instructions

START OPERATION

1. Make sure the plug is inserted firmly into the socket.
2. Make sure the water tank is placed in the proper position. If the full tank light is on when turning on the machine for the first time, pull out the water tank and push it back into proper position.

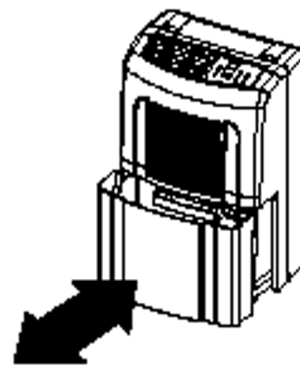

WHEN FULL TANK LIGHT IS ON

When the water tank is full, the indicator light will light up and the dehumidifier will stop operating. Empty the water tank and place it back in its proper position. The machine will reactivate after 3 minutes.

Note: Empty the water from the water tank using two hands.



Continuous Drainage

The continuous drainage function can be activated using the following steps.

1. Prepare PVC hose to drain out water. Remove the cap from drainage outlet.
2. Remove flat rubber insert from cap.
3. Pull the drainage hose through the ring of the cap.
4. Align the hose with the water outlet on the unit first and then fasten the cap back on to the outlet.
5. Place the bucket in its original location.

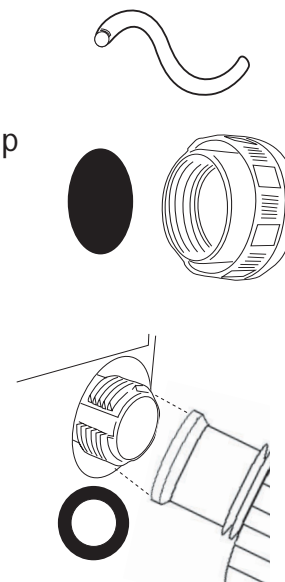

INSTALLING DRAINAGE PVC HOSE

When using the continuous drainage function, the PVC hose must be placed horizontally below the drainage hole. Avoid folding the hose or placing it on an uneven surface.

Caution!

- Do not pull the power cord to remove the plug from the socket. Always pull on the plug.
- Do not use bug spray, oil, spray paint or other flammable materials near the machine. This can cause damage to the plastic parts or start a fire.
- To avoid shaking, noise and water leakage, do not place the unit on an uneven surface.
- Always keep the unit 8" (20 cm) away from the wall to allow heat to dissipate properly. Hang clothing at least 20" (50 cm) above the machine.
- It is dangerous to insert anything into the machine.
- Close all windows to reach maximum possible efficiency.
- Keep the machine away from all sources of heat.
- When moving or storing the dehumidifier, do not place it sideways or upside down. Avoid violent shaking.

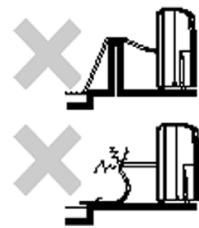
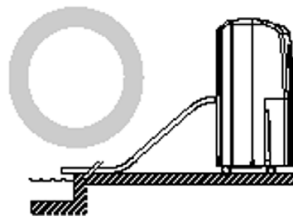

MAINTENANCE

For safety reasons, make sure the dehumidifier is unplugged before servicing or cleaning.

1. Cleaning the shell:
 - A. Wipe the shell with a clean, soft cloth.
 - B. If the dehumidifier is very dirty use mild detergent and wipe with a damp cloth.
 - C. Do not wash the machine with a hose or immerse it in water. This may cause an electrical shortage.
2. Cleaning the air filter:

The purpose of the air filter is to filter dust and other materials from the air. If the filter is blocked by dust the electricity usage will be greater than normal. For optimal moisture removal efficiency, clean the filter every two weeks.

Cleaning steps:

- A. Pull the air filter out slowly.
- B. Clean the filter with a vacuum cleaner or wash it with clean water and dry with a dry cloth.
- C. Put the clean air filter back in place and continue to operate the dehumidifier.



EMERGENCY

If a problem occurs, unplug the machine and contact a qualified service center immediately. Do not disassemble the dehumidifier yourself.

Troubleshooting

Before calling, read the following section. It will help you solve some common problems that might occur and can be easily corrected. If all attempts fail and you need service, please call the toll free number to contact customer service.

ITEMS TO CHECK BEFORE CALLING FOR SERVICE:

Unit not operating:

- Make sure the plug is pushed completely into the outlet.
- The fuse may be blown or the circuit may have been tripped. Check the house fuse/circuit breaker. Replace fuse or reset circuit breaker if necessary.
- The bucket may be full. The dehumidifier automatically turns off when this occurs. Empty the drain bucket.

Dehumidifier is icing up during initial stage of operation:

- This is normal. Frost will usually disappear within 60 minutes.

Airflow is restricted:

- Make sure there are no curtains, blinds or furniture blocking the front or back of the dehumidifier.
- Clean the filter.

Unsatisfactory dehumidification:

When first installed, allow at least 3 or 4 days for the moisture from the room to be removed and desired dryness to be maintained.

- Area to be humidified may be too large. Check with dealer to be sure model is suitable for room size and moisture level.
- The controls may not be set correctly. Adjust controls according to instructions.
- Doors and windows may not be closed. Check that all doors, windows and other openings are closed tightly.
- Clothes dryer may be in operation in the same room. Install the dehumidifier away from the moisture-laden air generated by the dryer. Dryer should be vented to the outside.
- Room temperature may be too low. The unit will not operate if the room temperature is below 41°F.

Safety Precautions

- Do not fold or knot the power cord.
- Make sure the plug is inserted firmly and properly into the outlet.
- Do not insert multiple plugs into the electrical socket.
- Make sure the plug is clean.
- Before turning off the dehumidifier, unplug the power cord.
- Do not plug in the power cord if hands are wet.

CAUTION

- Do not place anything on top of the control panel.
- Do not cover the machine's air vents.
- Do not allow children to climb on or play with the machine.
- Do not wet the machine or control panel.
- Keep flammable materials away from the machine.
- Contact a professional for service and repair.

Limited Warranty

This warranty covers all defects in workmanship or material for:

1. The mechanical and electrical parts (including labor costs) contained in this Haier product, for a period of 12 months from the date of purchase. (For commercial or rental application the warranty is 90 days.)
2. The sealed system and compressor contained in this Haier product is for a period of 5 years, from the date of purchase (excluding labor costs after the initial 12 month period). In commercial or rental use, the additional limited compressor warranty is for 1 year and 9 months, (excluding labor costs after the initial 90 days period).

You must keep and be able to provide your original sales receipt as proof of the date of purchase.

Who is covered?

The original retail purchaser of this Haier product.

What will be done?

Haier will repair or replace, in your home, any mechanical, electrical part or the compressor, which proves defective in normal household, use for a period of 12 months. Haier will repair or replace (excluding labor costs) the sealed system and compressor (parts only) for an additional 4 year period.

How can you get service?

1. Contact your nearest Haier authorized Service Depot. For the name of the Service Depot nearest you, contact Haier at (877) 337-3639.
2. All service must be performed by an authorized Haier Service Depot.
3. This is carry-in service only.

THIS WARRANTY COVERS UNITS WITHIN THE CONTINENTAL UNITED STATES, CANADA AND PUERTO RICO.

THIS WARRANTY DOES NOT COVER:

Damages from improper installation.

Damages in shipping.

Damages from misuse, abuse, accident, alteration, lack of proper care and maintenance.

Damages from service by other than an authorized dealer or service center.

Labor, service, transportation and shipping charges for the removal of defective parts and installation of replacement parts beyond the initial 12-month period.

THIS LIMITED WARRANTY IS GIVEN IN LIEU OF ALL OTHER WARRANTIES, EXPRESS OR IMPLIED, INCLUDING THE WARRANTIES OF MERCHANTABILITY AND FITNESS FOR A PARTICULAR PURPOSE.

The remedy provided in this warranty is exclusive and is granted in lieu of all other remedies. This warranty does not cover incidental or consequential damages. Some states do not allow the exclusion of incidental or consequential damages, so this limitation may not apply to you. Some states do not allow limitations on how long an implied warranty lasts, so this limitation may not apply to you. This warranty gives you specific legal rights and you may also have other rights, which vary from state to state.

IMPORTANT

Do Not Return This Product To The Store

If you have a problem with this product, please contact the "Haier Customer Satisfaction Center"
at 1-877-337-3639.

DATED PROOF OF PURCHASE, MODEL # AND SERIAL # REQUIRED FOR WARRANTY SERVICE

IMPORTANT

Ne pas retourner cet article au magasin

En cas de problème avec cet article, veuillez contacter le « Centre satisfaction client » de Haier
au 1-877-337-3639.

**UNE PREUVE D'ACHAT DATÉE, LE NUMÉRO DU MODÈLE ET LE NUMÉRO DE SÉRIE SONT
OBLIGATOIRES POUR BÉNÉFICIER DE LA COUVERTURE OFFERTE PAR LA GARANTIE.**

IMPORTANTE

No Devuelva Este Producto al Establecimiento Compra.

Si tiene problemas con este producto, por favor póngase en contacto con el "Centro Haier de
Atención al Cliente" en el 1-877-337-3639.

**PARA EL SERVICIO DE GARANTÍA SE REQUIERE PRUEBA DE COMPRA, FECHADA, No. DE MODELO
Y No. DE SERIE**

Made in China

Haier



Haier America
New York, NY 10018