

MANUAL

Dehumidifier

PD161C

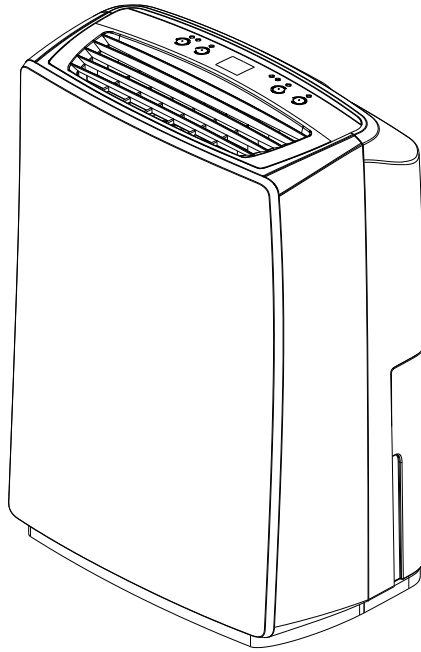

Please read the manual carefully and keep them properly before using.

Dear users:

Thank you for purchasing our dehumidifier, hope it can bring comfort and convenience to your work and life. It is recommended that you keep the manual properly for future reference. Before using this product, please read the manual carefully to ensure that the product performs its best function.

TABLE OF CONTENTS

1. Important Safety Instructions	1
2. Parts Description	3
3. Operation	4
4. Care & Cleaning	9
5. Troubleshooting	10
6. Safety Precautions	11
7. Technical Specifications	12

Important Safety Instructions

SAVE THESE INSTRUCTIONS/FOR HOUSEHOLD USE ONLY

To prevent injury to the user or other people and property damage, the following instructions must be followed when using the Dehumidifier. Incorrect operation due to ignoring of instructions may cause harm or damage.

1. Do not exceed the rating of the power outlet or connection device.
2. Do not operate or turn off the dehumidifier by plugging in or unplugging the device. Use the control panel instead.
3. Do not use if the power cord is broken or damaged.
4. Do not modify the power cord length or share the outlet with other appliances.
5. Do not touch the plug with wet hands.
6. Do not install the dehumidifier in a location that may be exposed to combustible gas.
7. Do not place the dehumidifier near a heat source.
8. Disconnect the power if strange sounds, smell, or smoke comes from the dehumidifier.
9. You should never try to take apart or repair the dehumidifier by yourself.
10. Make sure to turn off and unplug the dehumidifier before cleaning.
11. Do not use the dehumidifier near flammable gas or combustibles, such as gasoline, benzene, thinner, etc.
12. Do not drink or use the water drained from the dehumidifier.
13. Do not take the water bucket out while the dehumidifier is working.
14. Do not use the dehumidifier in small spaces.
15. Do not place the dehumidifier in places where it may be splashed by water.
16. Place the dehumidifier on a level, sturdy section of the floor.
17. Do not cover the intake or exhaust openings with cloths or towels.
18. Care should be taken when using the dehumidifier in a room with the following persons; infants, children, the elderly and people not sensitive to humidity.
19. Do not use in areas where chemicals are handled.
20. Never insert your finger or other foreign objects into grills or openings. Take special care to warn children of these dangers.
21. Do not place a heavy object on the power cord and make sure that the cord is not compressed.
22. Do not climb on or sit on the dehumidifier.
23. Always insert the filters securely. Make sure to clean the filter once every month.
24. If water enters the dehumidifier, turn the dehumidifier off and disconnect the power, contact Inofia Customer Service in order to avoid a hazard.

Important Safety Instructions

ELECTRICAL INFORMATION

- The Inofia nameplate is located on the left side of the dehumidifier and contains electrical and other technical data specific to this dehumidifier.
- Be sure the dehumidifier is properly grounded. To minimize shock and fire hazards, proper grounding is important. This power cord is equipped with a three-prong grounding plug for protection against shock hazards.
- Your dehumidifier must be used in a properly grounded wall socket. If your wall socket is not adequately grounded or protected by a time delay fuse or circuit breaker, have a qualified electrician install the proper socket.
- Avoid fire hazard or electric shock. Do not use an extension cord or an adapter plug. Do not remove any prong from the power cord.

CAUTION

- This dehumidifier can be used by children 8 years or older and person with reduced physical, sensory or mental capabilities or lack of experience and knowledge with supervision or instruction concerning use of the dehumidifier. Cleaning and user maintenance shall not be done by children without supervision.
- Prior to cleaning or other maintenance, the dehumidifier must be disconnected from the supply mains.
- Do not install the dehumidifier in a location that may be exposed to combustible gas.
- If combustible gas accumulates around the dehumidifier, it may cause fire.
- If the dehumidifier is knocked over during use, turn off the dehumidifier and unplug it from the main power supply immediately. Visually inspect the dehumidifier to ensure there is no damage. If you suspect the dehumidifier has been damaged, contact Inofia Customer Service for replacement.
- In a thunderstorm, the power must be cut off to avoid damage to the dehumidifier due to lightning.
- Do not run cord under carpeting. Do not cover cord with throw rugs, runners, or similar coverings. Do not route cord under furniture or other appliances. Arrange cord away from traffic area and where it will not be tripped over.
- To reduce the risk of fire or electric shock, do not use this dehumidifier with any solid-state speed control device.
- The dehumidifier shall be installed in accordance with national wiring regulations.

Parts Description

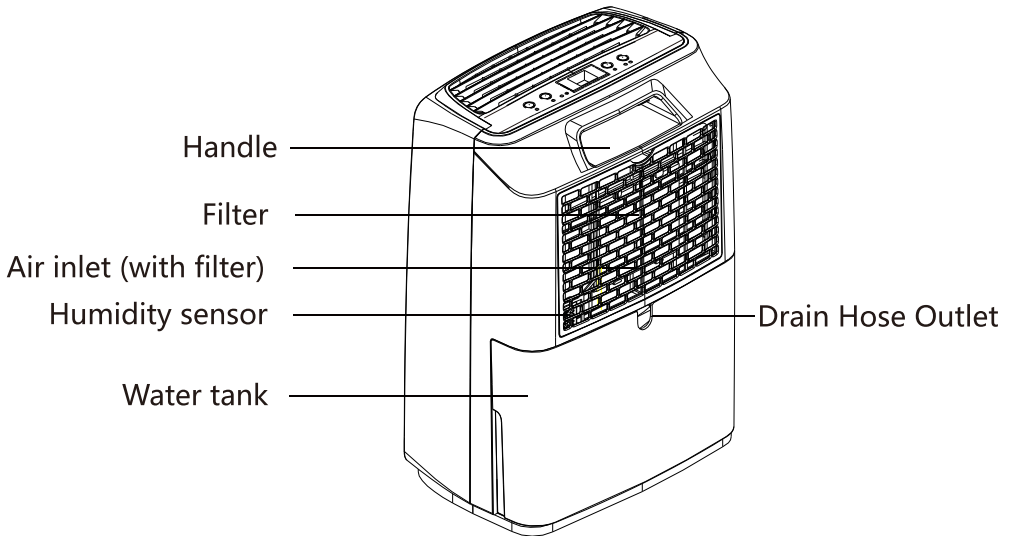
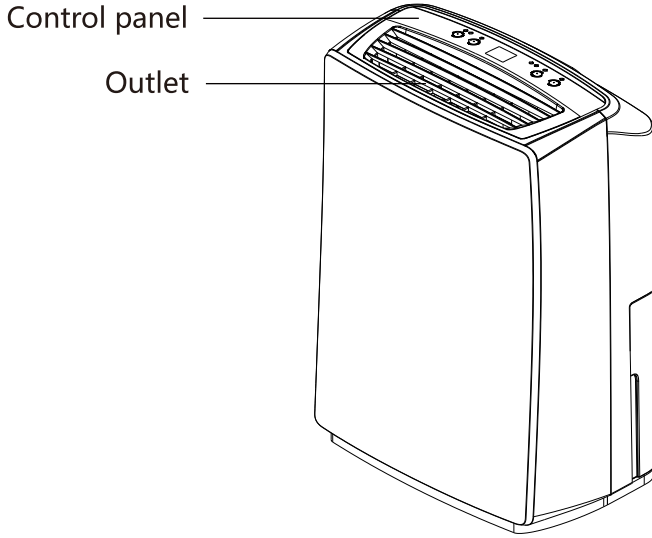

Operation

PLACE CORRECTLY

- This unit may have been tilted or placed upside down during shipping. To ensure this device works properly, please ensure this unit is upright for at least 24 hours before initial use.
- This dehumidifier is designed to operate with a working environment between 41°F (5°C) and 100°F (38°C).
- When the dehumidifier is in use, it should keep at least 20cm away from the surrounding objects.

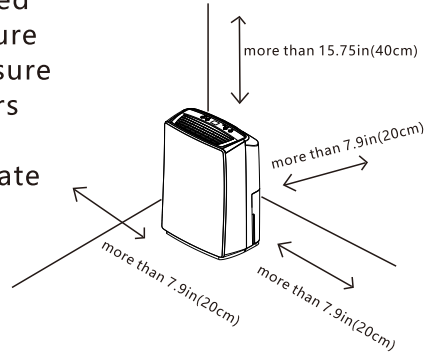

SMART FUNCTIONS

- Auto Shut Off
When the bucket is full, the dehumidifier will be shut off automatically.
- Wait 3 minutes to start the compressor
Power on : after the fan starts, the compressor starts with a delay of several seconds. In the startup state, resume after power off, the fan will start directly, but the compressor is delayed for 3 minutes to start. Shutdown: compressor immediately stop, fan delay several seconds stop. (when other faults or desired humidity is reached, the fan will be delayed for dozens of seconds to stop.) the compressor has a 3-minute delay protection function, that is, under the condition of power on, the compressor will resume after it stops for 3 minutes.
- Auto Defrost
When running in a low temperature, the dehumidifier will automatically detect whether there is frost, if there is frost, it will defrost automatically. While on defrost, the fan runs at high wind speed and compressor stops, the indicator light flashing.

Operation

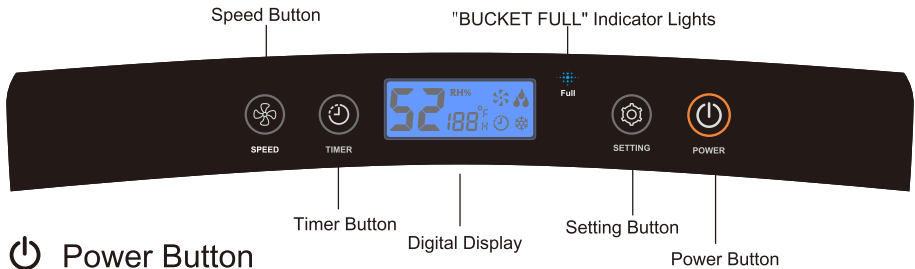

1. Power Button

Press to turn the dehumidifier on and off.

2. Setting Button

The humidity level can be set within a range of 30%RH to 80%RH in 5% increments. When it start work, it will first automatically detect and show the humidity(and temperature) in the room, then you can press or hold the Setting Buttons to change the humidity selection in 5% increments. (After you have set the desired humidity, the readout will display the actual room humidity.) When the room humidity level overtake or drops to the level you set, the dehumidifier will automatically begin working or stop. When the humidity level is set at 30%RH, the dehumidifier will be at CONTINUOUS dehumidifying mode.

3. Timer Button

The TIMER function enables you to either Delay Start or Delay Stop the unit in the choice from 1 hour to 24 hours. If the unit is running, then selecting Timer will turn the unit off in the hours that will be set (Delay Stop). If the unit is off, then selecting Timer will turn the unit on in the hours that will be set (Delay Start).

TIMER setting: Pressing or holding the Timer Button to change the delay timer at 1 hour increments, up to 24 hours. After TIMER setting finishes, the control will display the time remaining (8,7,6, etc.) until the unit either starts or stops. If then pressing TIMER button again, the control will display the room temperature like before. After that, pressing TIMER button again at any time will stop the TIMER function. For the Delay Start, the fan speed and humidity maintained will be the same as previous setting. Adjusting the timer setting to 0.0 will cancel the Auto Start/Stop function.

NOTE

- Before entering TIMER setting, make sure power is being supplied to the unit.
- Before entering TIMER setting, make sure pressing Setting Button sets one desired room humidity first.

Operation

4. Speed Button

Control the fan speed. Press to select either High or Normal fan speed. A higher fan speed will result in quicker moisture removal. Set the fan control to High for maximum moisture removal. When the humidity has been reduced and quiet operation is preferred, set the fan control to Normal.

5. "BUCKET FULL" Indicator Lights

When the bucket is full, the light will flash and the machine will automatically shut off. After the water in the bucket is emptied, put the bucket back in place, then the indicator will go out, and the machine will restart.

6. Auto Defrost Feature

When the dehumidifier is running at a lower temperature, the system will automatically determine if there is frost, and if frost is present, it will automatically defrost.

Defrost action: The fan runs at high wind speed while the compressor stops, and the LED screen display the defrosting symbol.

Action Description

Power on:

Compressor start after fan work a few seconds.

Power off:

Compressor shut down at once, after a few seconds, the fan stop (when other malfunctions occurs or humidity reached the desired level, the fan will stop after tens of seconds).

Tips: The compressor features "3 minutes delay protection" function —— While the dehumidifier is powered, the compressor can only start again three minutes after its last shutdown.

Fault & Protection Codes:

Number	Error code	Error code meaning
1	E1	Humidity sensor error
2	E2	Defrost Temperature sensor error
3	E4	Room temperature sensor error
4	E7	Water full alarm

Note: When one of the above malfunctions occurs, turn off the dehumidifier, and check for any obstructions. Restart the dehumidifier, if the malfunction is still present, turn off the dehumidifier and unplug the power cord. Contact Inofia Customer Service for replacement.

REMOVING THE COLLECTED WATER

There are two ways to remove collected water:

1. Use the water tank

When the water tank is full, remove the water tank and empty it.

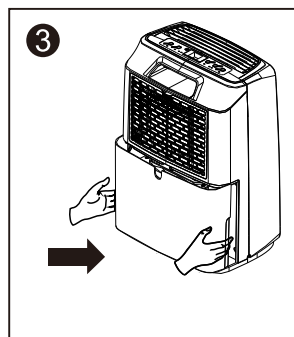
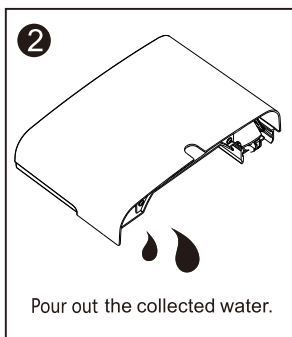
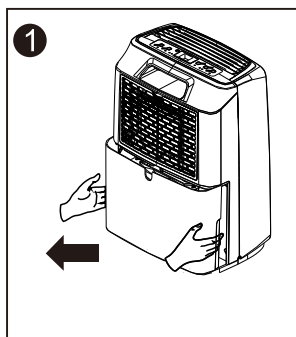

Note: Do not remove the floater from the water tank, if the floater is removed, the water full sensor will not be able to normally sense the water level, causing the water will overflow from the tank when the water full. If the tank is dirty, only can be cleaned with cold or warm water, do not use detergent, steel wool, chemical processing dust cloth, gasoline, benzene, thinner or other solvent treatment, otherwise it may be damaged to cause leakage. When installing water tank, press the tank with two hands, if the tank not be placed well, water full sensor is still be activated, the dehumidifier can not work.

Operation

2. Continuous draining

Water can be automatically be emptied into a floor drain by attaching the dehumidifier to a water hose.

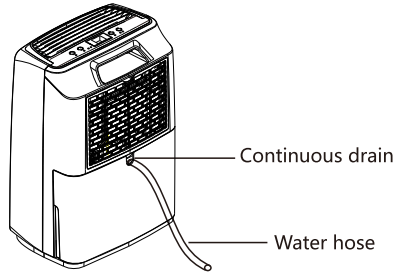

Note: Do not use this operation when the outdoor temperature is equal to or less than 32°F (0°C), otherwise the water will freeze, causing the water hose to block up and the dehumidifier may be damaged.

Continuous drainage Pipe installation

Picture 1: Example of error connection

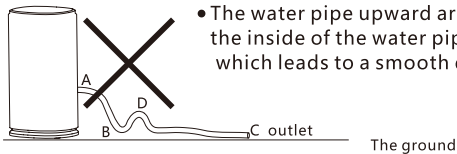

- The water pipe upward arch position D above position B, the inside of the water pipe is prone to air and accumulation, which leads to a smooth discharge through the Pipe.

Picture 2: Example of error connection

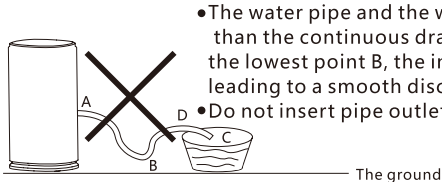

- The water pipe and the water container contact point D is lower than the continuous drain A, but higher than the water pipe at the lowest point B, the inside of the pipe prone to air and water, leading to a smooth discharge of waters through the Pipe.
- Do not insert pipe outlet C into water.

Picture 3: Example of a correct connection

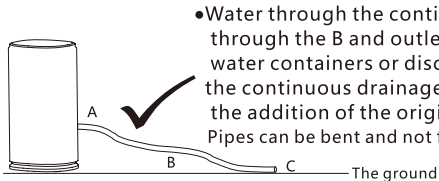

- Water through the continuous drainage port A, from high to low through the B and outlet C smooth discharge, can be used to water containers or discharged into the sewer (outlet C is below the continuous drainage port of 10 cm above, do not recommend the addition of the original drainage pipe). Pipes can be bent and not folded on the ground, but cannot be partially arched.

The picture is for reference only.

CARE AND CLEANING OF THE DEHUMIDIFIER

WARNING: Turn the dehumidifier off and remove the plug from the wall outlet before cleaning.

1. Clean the air filter

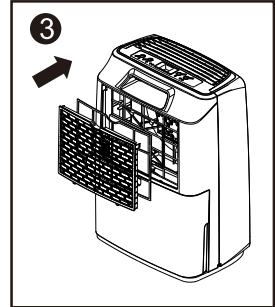
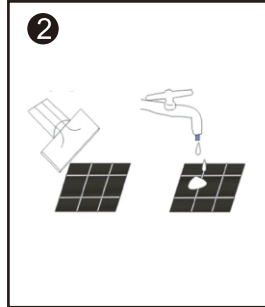
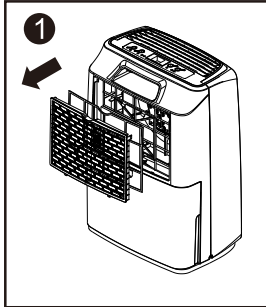

1. Pull up to remove the air filter.
2. Cleaning: Run a vacuum cleaner lightly over the surface of air filter to remove dirt. If the air filter is exceptionally dirty, wash it with warm water and a mild cleanser and dry thoroughly.
3. Insert the filter into the unit smoothly.

2. Storing the dehumidifier

When not using the dehumidifier for long time periods

- After turning off the dehumidifier, wait one day before emptying the water tank.
- Clean the main dehumidifier, water tank and air filter.
- Wrap the cord and bundle it with the band.
- Cover the dehumidifier with a plastic bag.
- Store the dehumidifier upright in a dry, well-ventilated place.

Troubleshooting

Before calling Inofia customer service, review this list. It may save you time and expense. This list includes the most common occurrences that are not the result of defective workmanship or materials in this dehumidifier.

PROBLEM	CAUSE
Dehumidifier does not start	<ul style="list-style-type: none"> - Make sure the dehumidifier's plug is inserted completely into the outlet. - Check the house fuse/circuit breaker box. - Dehumidifier has reached its preset level or bucket is full. - Bucket is not in the proper position. - Make sure room temperature above 95°F(35°C) or below 41°F(5°C), the machine will protect automatically if the room temperature over heat or over cold, it is normal phenomenon. - Make sure the room temperature in range of 41°F(5°C) to 68°F(20°C), the machine will auto defrost, it is normal phenomenon.
Dehumidifier does not dry the air as it should	<ul style="list-style-type: none"> - Did not allow enough time to remove the moisture. - Make sure there are no curtains, blinds or furniture blocking the front or back of the dehumidifier. - The humidity selector may not be set low enough. - Check that all doors, windows and other openings are securely closed. - Room temperature is too low, below 41°F (5°C). - There is a kerosene heater or something giving off water vapor in the room.
The dehumidifier makes a loud noise when operating	<ul style="list-style-type: none"> - The air filter is clogged. - The dehumidifier is tilted instead of upright as it should be. - The floor surface is not level.
Frost appears on the coils	<ul style="list-style-type: none"> - This is normal. The dehumidifier has Auto defrost feature
Water on floor	<ul style="list-style-type: none"> - Hose to connector or hose connection may be loose. - Intend to use the bucket to collect water, but the back drain plug is removed.

Please contact Inofia Customer Service if dehumidifier operates abnormally or does not operate, and the solutions above are not useful.

Safety precautions



Do not place unit on uneven surface.

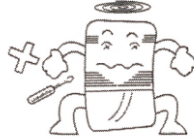

Do not insert any sharp objects into air inlet/airoutlet.



Do not operate unit near radiators, kettles or any object that releases steam.



Do not operate unit near windows or doors opening to the outdoor.

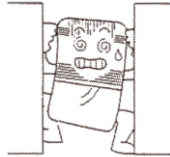

Do not obstruct air inlet and outlet.



Unplug power when the unit is not in use for an extended period.



Do not spray any liquid onto unit.



Do not put heavy objects on top of unit.



Wash the air filter once every 2 weeks with cold water. (Do not use water >40 or benzene)



When draining water continuously, make sure drain hose is not tangled.



Do not place filter directly under



Empty water tank before moving unit.

Technical specifications

MODEL NAME	DEHUMIDIFIER
MODEL	PD161C
POWER SOURCE	110-120V ~ 60Hz
RATED POWER	200W
RATED CURRENT	2.0A
INPUT POWER(80°F, RH60%)	160W
INPUT CURRENT(80°F, RH60%)	1.7A
MOISTURE REMOVAL(80°F, RH60%)	11.5PTS/Day(5.45L/Day)
INPUT POWER(86°F, RH80%)	180W
INPUT CURRENT(86°F, RH80%)	1.8A
MOISTURE REMOVAL(86°F, RH80%)	22.5PTS/Day(10.7L/Day)
INPUT POWER(95°F, RH90%)	260W
INPUT CURRENT(95°F, RH90%)	2.6A
MOISTURE REMOVAL(95°F, RH90%)	32.7PTS/Day(15.5L/Day)
WATER TANK CAPACITY	1.8L
MOTOR FLA	0.19A
MOTOR COMPRESSOR	RLA:1.75A LRA:11A
REFRIGERANT	R134a/3.7ozs(105g)
HIGH PRESSURE	232PSIG(1.6MPa)
LOW PRESSURE	90PSIG(0.62MPa)
DIMENSIONS	310*210*440mm
WEIGHT	10.8kg

The Company reserves the right to change the product, the above parameters are subject to change without notice.

说明书

PD161C (110V~60Hz) (无负离子) (Inofia)

30700401268-06 307-2491 (00版本)

设计：梁才亮 2019.04.01

审核：

批准：

与00版区别：

特别说明：虚线框内内容非印刷内容，无需印刷

Remark: all the product drawings involved in this manual shall be subject to the object.

All the contents of this manual have been strictly checked and proofread, but there is possibility of incorrect typesetting or printing. Please feel free to understand