

# Inofia

YDA-828E

Dehumidifier

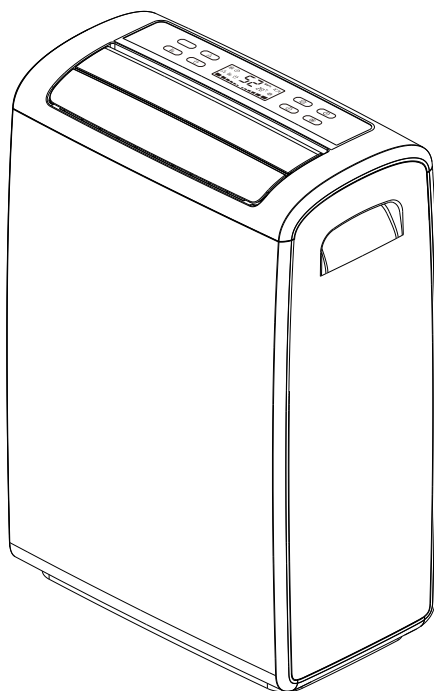

Please read this manual carefully before using product

OPERATING INSTRUCTIONS

Dear user,

Thank you for purchasing our dehumidifier, hope it can bring comfort and convenience to your work and life. It is recommended that you keep the manual properly for future reference. Before using this product, please read the manual carefully to ensure that the product performs its best function.

### Drying instructions

1. The dehumidifier can be used in the wet weather to dry clothes, You only need to hang up the washed clothes in a small space such as a cloakroom, bathroom or storage room (note: not drip on the machine), open dehumidifier, set the humidity value at 30%(if there is "a key drying" or "dehumidification", please click this button), blew to the clothes directly, the effect will be better.
2. The drying effect will vary according to the thickness of your clothes, the number of clothes, and the size of the drying space. It will take about 3-8 hours. In principle, clothings is thinner, the quantity is less, the space is smaller, the effect is better, time is shorter, the drying time will depend on your demand, continuous drainage is recommended when drying clothes.

# TABLE OF CONTENTS

Important Safety Instructions	P.01
Parts Description	P.02
Operation	P.03
Care & Cleaning	P.09
Troubleshooting	P.10
Safety Precautions	P.11
Technical Specifications	P.12

## Statement

The graphics and functions provided in this manual may be different from the physical products. Please refer to the physical products and the actual model. With the technical innovation and improvement of the product, the contents of the product manual of the same model may be changed without prior notice.

The machine model in the manual is for reference only, Please check the content operation according to physical product.

The right of interpretation of this article belongs to the company.

## Important Safety Instructions

To prevent injury to the user or other people and property damage, the following instructions must be followed when using the Dehumidifier. Incorrect operation due to ignoring of instructions may cause harm or damage.

1. Do not exceed the rating of the power outlet or connection device.
2. Do not operate or turn off the dehumidifier by plugging in or unplugging the device. Use the control panel instead.
3. Do not modify the power cord length or share the outlet with other appliances.
4. Do not install the dehumidifier in a location that may be exposed to combustible gas.
5. Do not place the dehumidifier near a heat source.
8. Disconnect the power if strange sounds, smell, or smoke comes from the dehumidifier.
9. You should never try to take apart or repair the dehumidifier by yourself.
10. Make sure to turn off and unplug the dehumidifier before cleaning.
11. Do not use the dehumidifier near flammable gas or combustibles, such as gasoline, benzene, thinner, etc.
12. If the dry clothes function is used, the clothes should be kept at least 40cm away from the air outlet to prevent water from entering the machine and damage the machine.
13. Do not use the dehumidifier in a closed, narrow space.
14. Do not place the dehumidifier in places where it may be splashed by water.
15. The fixed wiring of the machine connection must be equipped with an all-pole disconnect device (air switch) with a minimum of 3mm electric shock.
16. The fuse model specification is: 3.15A
17. Care should be taken when using the dehumidifier in a room with the following persons: infants, children, the elderly and people not sensitive to humidity.
18. When the machine is in use, it must be at least 20cm away from the surrounding objects, as shown in the figure.

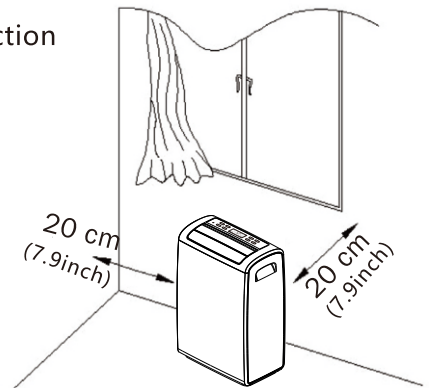



## Machine body

### Front

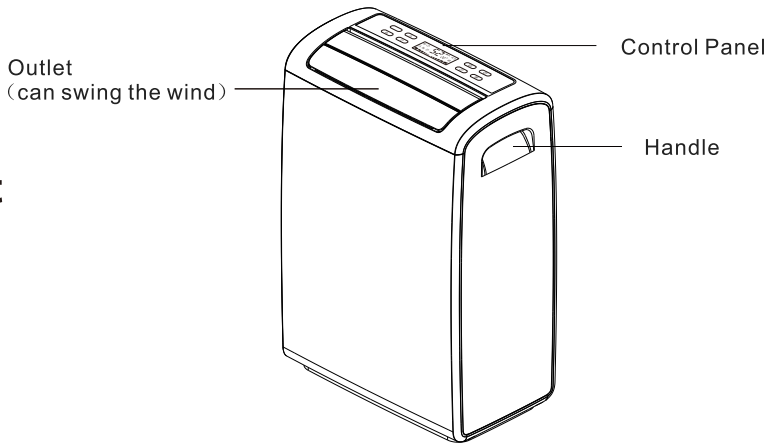

### Rear

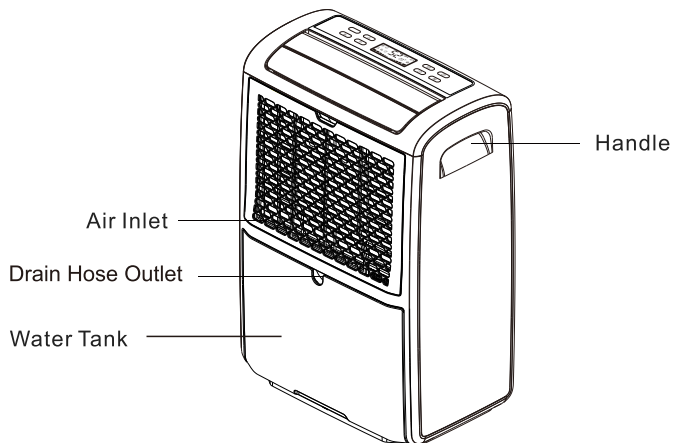

Note: The technical parameters of the product are subject to the nameplate on the product.

## Control Panel

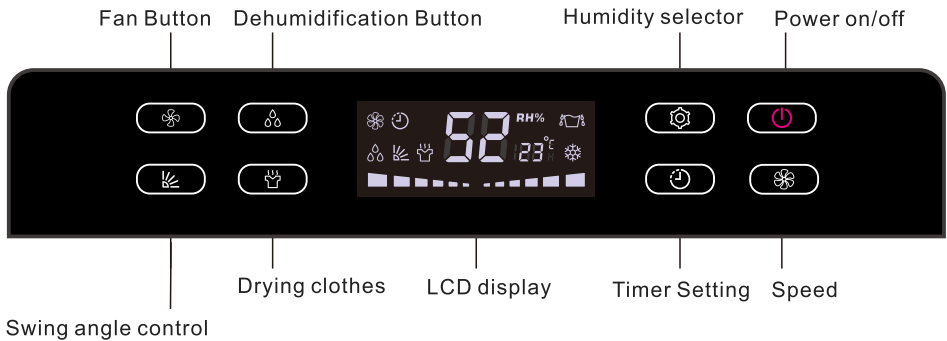

## Function button

### 1、 Power button

Press to turn the dehumidifier on and off.

### 2、 Humidity button

The humidity level can be set within a range of 30%RH to 80%RH in 5% increments, auto exit setting if no operation within 5 seconds. When the desired humidity is 30%RH, the machine continuous dehumidification operation. Please make sure the desired humidity should be lower than the current humidity at least 10%, otherwise the unit will not working.

### 3、 Timer button

Press it to initiate the Auto start and Auto stop feature.

- When the dehumidifier is on, first press the Timer button. The Timer indicator light will illuminate.It indicates the Auto Stop program is initiated. While the TIMER indicator light illuminates, touch it again to see the remaining timing.
- When the dehumidifier is off, first touch the Timer button. The TIMER indicator light illuminates. It indicates the auto start program is initiated. While the TIMER indicator light illuminates, touch it again to see the remaining timing.
- Press or hold the TIMER button to change the Auto time by 1 hour increments up to 24 hours. The control will count down the time remaining until start.
- When the Auto start & Auto stop times are set, TIMER indicator lights illuminate identifying TIMER ON OR OFF are now programmed.
- Adjusting the timer setting to 00 will cancel the Auto Start/Stop function.

### 4、 **Speed button**

Control the fan speed. Press to select either High or low fan speed. Set the fan control to High for maximum moisture removal. When the humidity has been reduced and quiet operation is preferred, set the fan control to low.

### 5、 **Fan button**

Press Fan button to start fan mode, compressor off, only fan works.

### 6、 **Swing Button**

Press Swing button to adjust the louver at the desired angle, when the louver swing to the angle you want, press the Swing button to stop the swing.

### 7、 **Drying Clothes button**

For start up drying clothes mode,press one time in the boot state,then the machine enter into dehumidification mode.

### 8、 **Dehumidification Button**

For start up dehumidification mode,press one time in the boot state, then the machine enter into dehumidification mode.

## **LCD display**

Shows the set % humidity level from 30% to 80% or auto start/stop time (0~24) while setting, then shows the actual ( $\pm 5\%$  accuracy) room % humidity level in a range of 30% RH (Relative Humidity) to 80%RH (Relative Humidity).

## SMART FUNCTIONS

### - Auto Shut Off

When the water tank is full , the dehumidifier will be shut off automatically.

### - Wait 3 minutes to start the compressor







Power on: after the fan starts, the compressor starts with a delay of several seconds. In the startup state, resume after power off, the fan will start directly, but the compressor is delayed for 3 minutes to start.

Shutdown: compressor immediately stop, fan delay several seconds stop. (when other faults or desired humidity is reached, the fan will be delayed for dozens of seconds to stop.) the compressor has a 3-minute delay protection function, that is, under the condition of power on, the compressor will resume after it stops for 3 minutes.

### - Auto Defrost

When running in a low temperature, the dehumidifier will automatically detect whether there is frost, if there is frost, it will defrost automatically. While on defrost, the fan runs at high wind speed and compressor stops, the indicator light flashing.

## Indicator Lights Description

- POWER. .... ① When the unit is powered on, only the power light will be on in the standby (shutdown) state.
- WATER FULL . ....  light, the water tank is full and should be emptied.
- TIMER . ....  Light indicates TIMER in progress.
- DEFROST. ....  Light indicates defrosting in progress.
- DEHUMIDIFY . ....  Light indicates dehumidify mode in progress or ambient temperature reach setting humidity.
- DRY CLOTHES . ....  Light indicates dry clothes mode in progress.
- SWING . ....  Swing mode in progress.
- SPEED . ....  Fan in high/low speed.

## Error Codes:

Number	Error code	Error code meaning
1	E1	Humidity sensor error
2	E2	Defrost Temperature sensor error
3	E4	Room temperature sensor error
4	E7	Water full alarm

### Note:

- When error happened, error code flashing on display, if there are more than one error, each error code display in turn, if only one error, the error code and the current humidity value are displayed alternately.
- When E1, E2 or E4 occurs, the machine can continue to dehumidification; Buzzer alarm and display the error code. After the power is disconnected and reconnected, the machine can still be dehumidified. After the alarm, the humidity of the environment may not continue to be controlled according to the set humidity.
- When the error occurs, the buzzer will alarm for a few seconds. During the alarm, press any button to remove the alarm sound.

### NOTE:

- Before use this dehumidifier, please make sure the outlet is opened, otherwise, this dehumidifier will be overheated.
- Do not stop the machine by unplugging the power cord directly. When the bucket is full of water, indicator light flashing, please turn off the unit, remove the bucket and empty it.

## REMOVING THE COLLECTED WATER

There are two ways to remove collected water:

### 1. Use the water tank

When the water tank is full, remove the water tank and empty it.

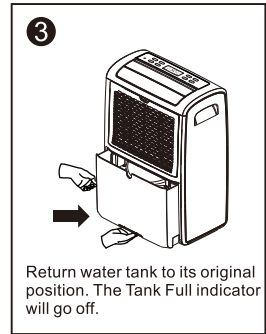
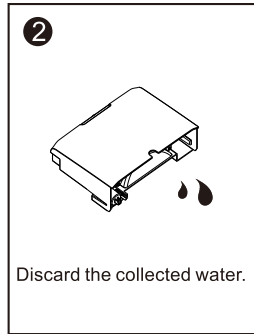
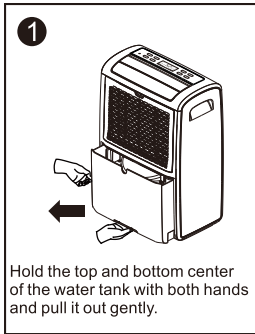

**Note:** Do not remove the floater from the water tank, if the floater is removed, the water full sensor will not be able to normally sense the water level, causing the water will overflow from the tank when the water full. If the tank is dirty, only can be cleaned with cold or warm water, do not use detergent, steel wool, chemical processing dust cloth, gasoline, benzene, thinner or other solvent treatment, otherwise it may be damaged to cause leakage. When installing water tank, press the tank with two hands, if the tank not be placed well, water full sensor is still be activated, the dehumidifier can not work.

# Operation

## 2. Continuous draining

Water can be automatically be emptied into a floor drain by attaching the dehumidifier to a water hose.

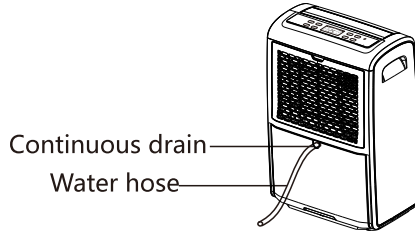

**Note:** Do not use this operation when the outdoor temperature is equal to or less than 32°F (0°C), otherwise the water will freeze, causing the water hose to block up and the dehumidifier may be damaged.

### Continuous drainage Pipe installation

Picture 1: Example of error connection

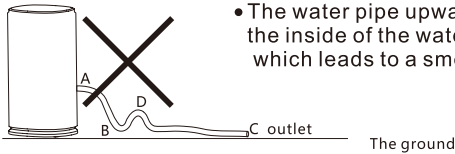

- The water pipe upward arch position D above position B, the inside of the water pipe is prone to air and accumulation, which leads to a smooth discharge through the Pipe.

Picture 2: Example of error connection

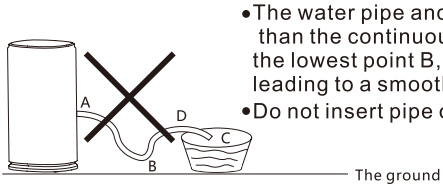

- The water pipe and the water container contact point D is lower than the continuous drain A, but higher than the water pipe at the lowest point B, the inside of the pipe prone to air and water, leading to a smooth discharge of waters through the Pipe.
- Do not insert pipe outlet C into water.

Picture 3: Example of a correct connection

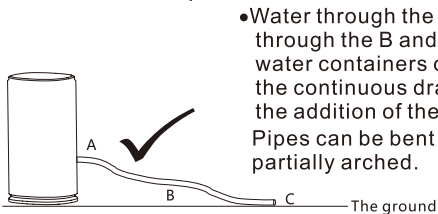

- Water through the continuous drainage port A, from high to low through the B and outlet C smooth discharge, can be used to water containers or discharged into the sewer (outlet C is below the continuous drainage port of 10 cm above, do not recommend the addition of the original drainage pipe).

Pipes can be bent and not folded on the ground, but cannot be partially arched.

The picture is for reference only.

### CARE AND CLEANING OF THE DEHUMIDIFIER

**WARNING:** Turn the dehumidifier off and remove the plug from the wall outlet before cleaning.

#### 1. Clean the air filter

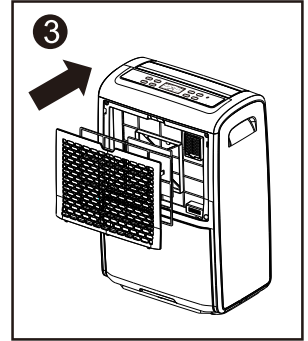
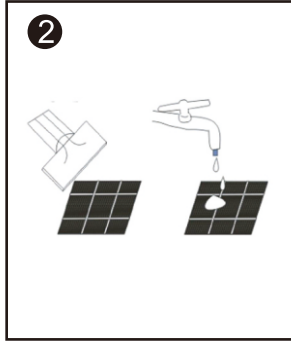
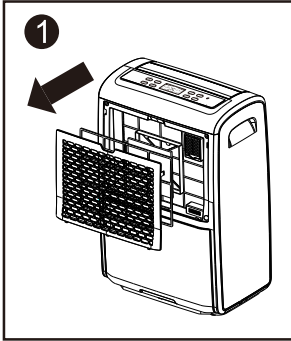

1. Pull up to remove the air filter.
2. Cleaning: Run a vacuum cleaner lightly over the surface of air filter to remove dirt. If the air filter is exceptionally dirty, wash it with warm water and a mild cleanser and dry thoroughly.
3. Insert the filter into the unit smoothly.

#### 2. Storing the dehumidifier

When not using the dehumidifier for long time periods

- After turning off the dehumidifier, wait one day before emptying the water tank.
- Clean the main dehumidifier, water tank and air filter.
- Wrap the cord and bundle it with the band.
- Cover the dehumidifier with a plastic bag.
- Store the dehumidifier upright in a dry, well-ventilated place.



## Troubleshooting

Before calling Inofia customer service, review this list. It may save you time and expense. This list includes the most common occurrences that are not the result of defective workmanship or materials in this dehumidifier.

PROBLEM	CAUSE
Dehumidifier does not start	<ul style="list-style-type: none"> <li>- Make sure the dehumidifier's plug is inserted completely into the outlet.</li> <li>- Check the house fuse/circuit breaker box.</li> <li>- Dehumidifier has reached its preset level or bucket is full.</li> <li>- Bucket is not in the proper position.</li> <li>- Make sure room temperature above 35°C or below 5°C, the machine will protect automatically if the room temperature over heat or over cold, it is normal phenomenon.</li> <li>- Make sure the room temperature in range of 5°C to 20°C, the machine will auto defrost, it is normal phenomenon.</li> </ul>
Dehumidifier does not dry the air as it should	<ul style="list-style-type: none"> <li>- Did not allow enough time to remove the moisture.</li> <li>- Make sure there are no curtains, blinds or furniture blocking the front or back of the dehumidifier.</li> <li>- The humidity selector may not be set low enough.</li> <li>- Check that all doors, windows and other openings are securely closed.</li> <li>- Room temperature is too low, below 41°F (5°C).</li> <li>- There is a kerosene heater or something giving off water vapor in the room.</li> </ul>
The dehumidifier makes a loud noise when operating	<ul style="list-style-type: none"> <li>- The air filter is clogged.</li> <li>- The dehumidifier is tilted instead of upright as it should be.</li> <li>- The floor surface is not level.</li> </ul>
Frost appears on the coils	<ul style="list-style-type: none"> <li>- This is normal. The dehumidifier has Auto defrost feature</li> </ul>
Water on floor	<ul style="list-style-type: none"> <li>- Hose to connector or hose connection may be loose.</li> <li>- Intend to use the bucket to collect water, but the back drain plug is removed.</li> </ul>

Please contact Inofia Customer Service if dehumidifier operates abnormally or does not operate, and the solutions above are not useful.

# Safety precautions

---



Do not place unit on uneven surface.

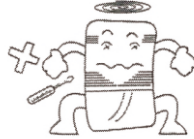

Do not insert any sharp objects into air inlet/airoutlet.



Do not operate unit near radiators, kettles or any object that releases steam.



Do not operate unit near windows or doors opening to the outdoor.



Do not obstruct air inlet and outlet.



Unplug power when the unit is not in use for an extended period.



Do not spray any liquid onto unit.



Do not put heavy objects on top of unit.



Wash the air filter once every 2 weeks with cold water. (Do not use water >40 or benzene)



When draining water continuously, make sure drain hose is not tangled.



Do not place filter directly under



Empty water tank before moving unit.

## Technical specifications

---

MODEL	YDA-828E
POWER SOURCE	110-120V ~ 60Hz
RATED POWER	450W
RATED CURRENT	4.1A
INPUT POWER(26.7°C, RH60%)	335W
INPUT CURRENT(26.7°C, RH60%)	3.1A
MOISTURE REMOVAL(26.7°C, RH60%)	23.8PTS/Day(11.3L/Day)
INPUT POWER(30°C, RH80%)	390W
INPUT CURRENT(30°C, RH80%)	3.6A
MOISTURE REMOVAL(30°C, RH80%)	43.5PTS/Day(20.6L/Day)
INPUT POWER(35°C, RH90%)	530W
INPUT CURRENT(35°C, RH90%)	4.8A
MOISTURE REMOVAL(35°C, RH90%)	69.6PTS/Day(33L/Day)
MOTOR FLA	0.35A
MOTOR COMPRESSOR	RLA:3.0A LRA:13.5A
REFRIGERANT	R134a/5.29ozs(150g)
HIGH PRESSURE	232PSIG(1.6MPa)
LOW PRESSURE	90PSIG(0.62MPa)
DIMENSIONS	360×225×545mm
WEIGHT	12.5kg

The Company reserves the right to change the product, the above parameters are subject to change without notice.