

IVATION™

PELTIER ERS DEHUMIDIFIER
User Guide



Thank you for purchasing our PelTier ERS Dehumidifier, and welcome to the Ivation™ family. This user manual is meant to offer you a brief walkthrough of the device's features and usage protocols. We hope you find this manual helpful. For additional information and technical support, please feel encouraged to contact our help team at info@myivation.com.

Distributed by
CAA Marketing, Inc.
18001
Rough Creek
Rough Creek, CA 95953
info@myivation.com
MADE IN CHINA
IVATION is a trademark of
CAA Marketing, Inc.
©2013 CAA Marketing, Inc.



Important Instructions

Intended Use
This device is intended for use in the removal of excess moisture from smaller rooms such as studios, walk-in closets and bathrooms. Other than the removable water tank, this device is not user serviceable and should not be disassembled. Any use other than that described above will lead to damage to the product and may present additional risks.

For Your Safety
If damage is incurred as a result of non-compliance with these operating instructions, manufacturer's guarantee will be voided. Ivation™ assumes no liability for personal injury or damage to property caused by incorrect handling or non-observance of the safety instructions.
1. Keep unit in upright position whenever in use.
2. To avoid electric shock, avoid opening unit.
3. Always turn device off when not in use.
4. Avoid using power adapter in excessively wet area.
5. Ensure that inlet and outlet grilles are unobstructed.
6. Keep device away from reach of children.

How Does it Work?
The PelTier ERS Dehumidifier works by way of thermoelectric cooling, which uses, which is known as the Peltier effect to create a heat/fuel between the junction of two different types of materials. Using no compressors or moving parts, the device pulls moisture from the air around it (removing mold/must and deposits from the room). An additional innovation is its ERS technology, which increases dehumidifying efficiency. Since the Peltier element is hot on one end and cold on the other, a delicate temperature balance must be kept between the two zones. ERS technology utilizes the extra energy from the cold end to steady the hot end, enabling the dehumidifier to convert much more moisture into collected water at the same power consumption.

One more feature is the photo catalytic oxidation (PCO) unit inside the air inlet, which uses the reactive between TCO and UV light to eliminate germs, bacteria, allergens, smoke, odors and volatile organic compounds (VOC). This ensures that cleaner, more purified air emerges from the air outlet.

Box Contents

- 1x PelTier ERS Dehumidifier
- 1x Removable Water Tank
- 1x Detachable Power Cord
- 1x User Manual

Parts & Controls

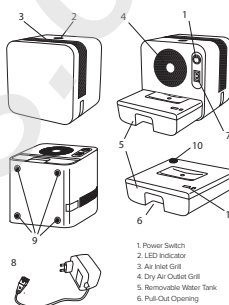

- 1. Power Switch
- 2. LED Indicator
- 3. Air Inlet Grill
- 4. Dry Air Outlet Grill
- 5. Removable Water Tank
- 6. Pull-Out Opening
- 7. DC Power Socket
- 8. AC/DC Power Adapter
- 9. Rubber Stability Feet
- 10. Water Displacement Hole with Plug
- 11. Hydraulic Cutoff

Operation

Basic:
- To remove excess moisture from small rooms, place unit in preferred area.
- Insert smaller end of AC/DC Power Adapter (8) into DC Power Socket (7).
- Connect other end to wall socket.
- Toggle Power Switch (1) to "I" position. LED Indicator (2) will light up blue.
- A purple LED light can also be seen inside Air Inlet Grill (3), indicating that PCO unit is on.
- To turn unit off at any time, toggle Power Switch (1) to "O" position first, then unplug AC/DC Power Adapter (8).

Emptying Water Tank:
- A full tank activates Hydraulic Cutoff (11) and unit automatically turns off.
- LED Indicator (2) will turn yellow.
- Before removing water tank, toggle Power Switch (1) to "O" position.
- Insert two fingers into Pull-Out Opening (6) and gently pull out.
- Pull out plug from Water Displacement Hole (10).
- Tilt and collect water out from tank into sink or tub.
- Reinsert plug and slide tank back into device until it clicks.
- Device is now ready for use again.

Technical Specifications

Capacity:	Approximately 1.5 Quarts/Day at 80°F, 80% RH
Water Tank Capacity:	22 Quarts
Cooling Element:	Thermoelectric Peltier Module
Suited for Area:	100-900 Square Feet
Power Consumption:	27w
Input:	AC100-240V 50/60Hz
Output:	9V 3A
Water Level Detector:	Auto-Off When Full w/ Yellow LED
Dimensions:	5.9" x 7" x 7.6"

Maintenance

Always turn unit off and disconnect power cord before cleaning unit. Use a piece of soft cloth to clean product surface, or use soft-bristled brush to wipe dust off air inlet grilles.