

# waykar

## Home Dehumidifier

Please read the manual carefully  
before using the unit

**PD100A**

USER MANUAL

## FOR CUSTOMERS

Thank you for purchasing our dehumidifier. **Waykar** wishes that our products and services can bring convenience to your work and life. We highly recommend that you keep the manual for reference if you encounter unexpected events using the unit. Please read the manual carefully to ensure the proper use of the dehumidifier. Our company's dehumidifiers are widely used in family bedrooms, bathrooms, basements, offices, storage rooms, etc. The dehumidifier from **Waykar** operates quickly and efficiently to reduce room's humidity and bring you a healthy and comfortable life.

## To Access Customer Support Faster

If there is any problem of the product, please contact Waykar Customer Service at [support@waykar.com](mailto:support@waykar.com) with your purchase Order ID to help us address the problem faster.

## BEFORE FIRST USE:

To prevent any internal damage, it is very important to keep refrigeration units (like this one) upright throughout their journey. Please leave it standing upright and outside the box for **24 HOURS** before plugging it in.

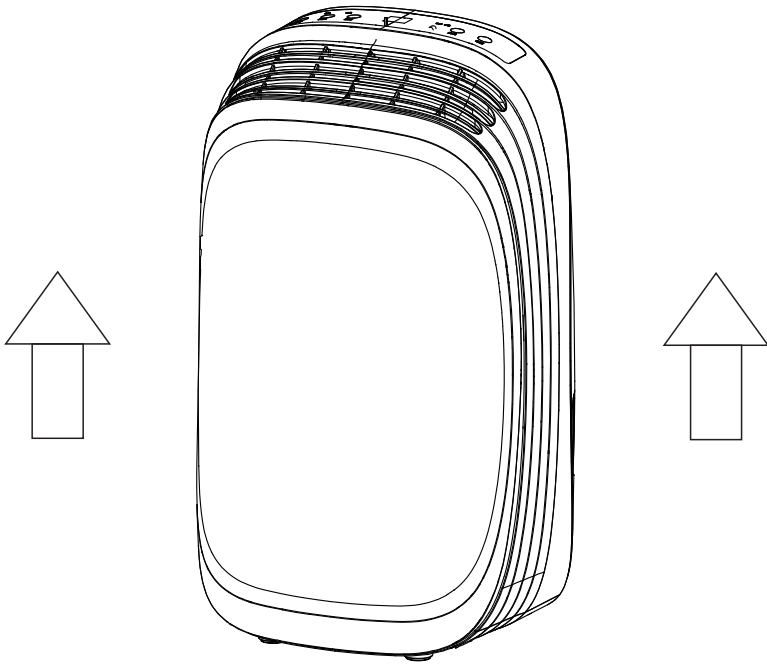

# CATALOG

Precaution For Use.....	01
Parts Description.....	02
Control Interface.....	03
Operation Instructions.....	04
Cleaning and Maintenance.....	09
Common Faults and Solutions.....	10
Safety Note.....	13
Technical Parameters.....	14
Warranty and Contact Us.....	15

## Statement

The graphics and functions provided in this manual may not be the same as the actual product. Please always refer to the actual product. The model of the machine on the manual is for reference only. Please check the corresponding content on this manual. This manual belongs to the company rights.

## PRECAUTIONS FOR USE

### SAFETY NOTES :

For the safety, please read the manual carefully and keep the manual before you use the product for reference. This product is only for the use of Home Furnishing, please use this product according to the installation and operation of this manual.

- When cleaning or storing a dehumidifier, pull out the plug.
- Do not spray water, pesticides or flammable liquids on this machine.
- Do not place the unit near the heater or flammable dangerous goods.
- Please don't put your finger or strip the articles into the air inlet or outlet.
- The machine level should be maintained, to avoid placing the machine on uneven or sloping ground.
- The machine must not be placed in the closed narrow space.
- If you use dry clothing function, clothing should be at least 40CM above the air outlet distance, so as to avoid water droplets on the clothes into the machine, so that the machine damaged.
- The machine power wiring must be in accordance with national wiring rules, power line and external grounding reliable connection.
- When power line is damaged, must be replaced by the technical staff of the company and approved or qualification
- The fixed wiring of the machine must be equipped with an extreme speed disconnect device (air switch) with at least 3mm contact opening distance.
- Model specification of safety tube 3.15A
- When the use of objects and surrounding the machine at least need to keep a distance of 7.9inches(20cm), as shown in picture

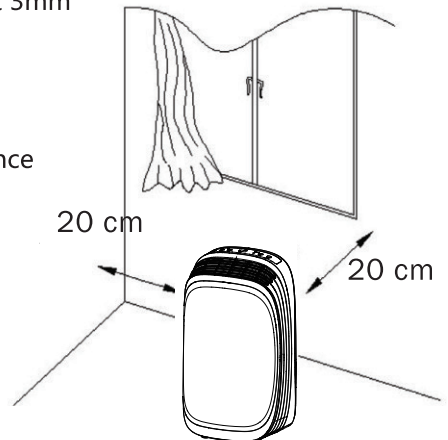

PARTS  
DESCRIPTION

PD100A

Side of machine



Back of machine

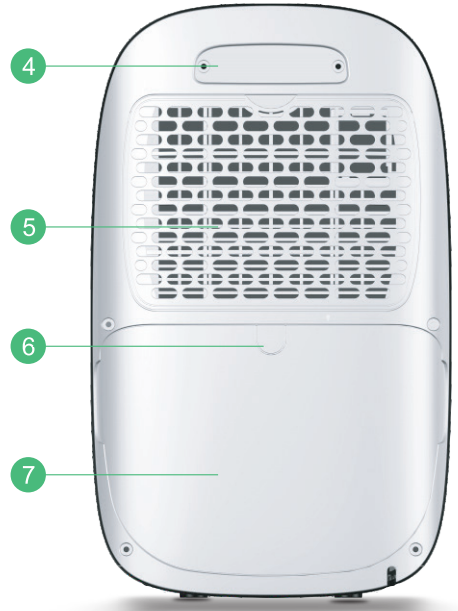

Product component description

- 1-Control panel    2-Outlet    3-Front cover    4-Handle  
5-Inlet    6-Continuous drain outlet    7-Water tank

# CONTROL INTERFACE

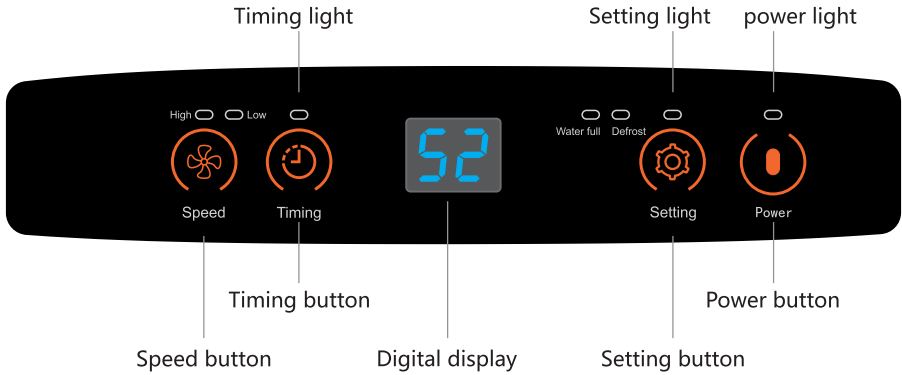

## Button description



### Power button

For control of machine switch machine, digital display and indicator light will be extinguished when shutdown.



### Speed button

Used to control high wind and low wind switching.



### Setting button

Used for setting humidity values.



### Timing button

Used for timing viewing and setting.

## A、Function setting



### Humidity setting

In the start up state, press setting button to enter the set humidity status: setting lights flashing, digital display **52** flashing and display the set humidity value, every click, set the humidity value increasing 5%RH, set the range of 30%~80%RH, can cycle setting.

Long press setting key can continuously set the humidity value.

Long time no keystroke operation, then exit the humidity setting state, digital display shows environment humidity value, setting lights off. When the humidity value is 30% RH, continuous dehumidification operation.



### Timing Setting

In the shutdown state, the timer is set to start up, in the start up state, the timer is set to the timing shutdown.

When timing function is not turn on, press timing button will enter the set state: timing lights flashing, digital display shows setting time and flashing, each click time increased 1 hours, setting range: 1~24 hours, cycle set. The timing is invalid when the timer time is 00.

When the timing is effective, the digital display shows environment humidity, timing light light up; press timing button once, the digital display can display the remaining timing, automatically display the value of environmental humidity after a few seconds.



### Wind speed setting

In the start up state, according to the speed button, can choose high speed or low speed.



## B、 Environmental temperature query

In the start up state, long press the timing button seconds, the digital display can display the ambient temperature, in seconds after the automatic display of environmental humidity value.

## C、 Water full protection

When the water tank is full, the machine stops and the water full light flashing; when the water full light is removed, the water light is put out and the machine can be restarted.

## D、 Defrost function

When running at a lower ambient temperature, the system will automatically determine whether there is frost, if frost will automatically defrost.

Defrosting action: high wind fan operation, compressor stop

Defrost display: when defrosting, defrosting lights flashing

## E、 Running instructions

Start : after fan start, delay seconds run the compressor, in the starting state, restart after power cut, the fan directly start, but the compressor delay 3 minutes to start.

Shutdown: immediately stop the compressor, fan delay a few seconds to stop. (other faults or humidity is reached, fan delay tens of seconds to stop)

The compressor has 3 minutes delay protection function, that is, in the state of power, the compressor stops for three minutes to start again.

## F、 State specification

- Shutdown state , power light off; delay start state, power light flashed; when the machine runs, the power light is on;
- When the humidity reaches the setting humidity and stops dehumidification (Humidity controlled state), the digital display and the power light flicker
- Set high wind speed, high light up; setting for low wind speed, low light up
- After the timer is effective, the timing light up, otherwise the light is out
- Defrosting light flashes when defrosting , on the contrary , it will off
- Water full light flashes when water full, on the contrary, it will off
- When the machine fails, the digital display will display the fault code

## G、 Fault code

No	Fault code	Fault name
1	E1	Humidity sensor fault
2	E2	Defrost temperature sensor fault
3	E4	Environmental temperature sensor fault
4	E7	Water full alarm

### Attention:

- When the E1, E2 or E4 fault, the machine continues to allow dehumidification, buzzer alarm and display fault code. Disconnect the power supply and the power is switched on again, the machine can still run dehumidification.
- When the fault occurs, the buzzer alarms seconds, and the alarm tone can be relieved by pressing any key during the alarm period.

## H、 Water tank drainage

- Before starting the machine, please ensure that the air outlet has been opened, otherwise the machine will overheat.
- Do not stop by directly unplugging the power line way.

When the water tank is full, the water is full of lights flashing, and then automatically stop, at this time must empty the water tank, and correctly placed the water tank.

### Empty the water tank



- Do not remove the floater in the water tank. If the floater of the water tank is removed, the water sensor will not be able to normally sense the water level, and the water will overflow from the water tank when the water is full.
- If the tank is dirty, only can be used in cold or warm water wash, do not use detergent, steel wool, chemical processing dust cloth, gasoline, benzene, thinner or other solvent treatment, otherwise it may cause damage to the tank Water Leakage.
- When the water tank is put into use, the water tank is pressed tightly by hand, and if the water tank is not put in tightness, the full water condition can not be relieved, and the machine can not run normally.

## I、 Continuous drainage

- In the need to use the external continuous drainage, use the tools such as knives or pliers to remove the plastic from the water tank continuously, and then insert the hose to realize the continuous drainage function;The outlet of water pipe should not be lower than 10cm for continuous drainage outlet, so as to ensure smooth drainage.



## CLEANING AND MAINTENANCE

### Warning

To avoid electric shock, the machine must be turned off before cleaning and maintenance, and remove the power plug

### A-Fuselage clean

Wipe the body with a soft, damp cloth

### B-Filter cleaning

- Pull out the filter
- Cleaning filter: use dust collector to gently suck the dust on the filter surface. If the filter is very dirty, wipe it with warm water and detergent and completely dry
- The screen slowly put back the fuselage

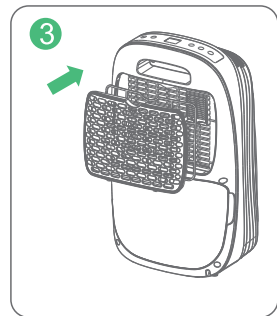
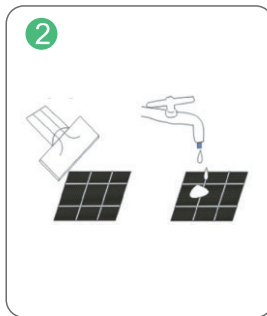
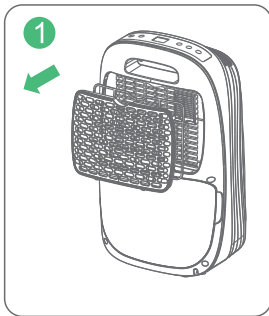

### C-Dehumidifier storage

If you don't use the dehumidifier for a long time and want to store it, pay attention to the procedure

1. Empty the water in the tank
2. rolls of power cord and tie well
3. Clean the filter
4. place the machine in a clean and dry environment

# COMMON FAULTS AND SOLUTIONS

Check the information below for troubleshooting steps that will save you time to resolve issues that may happen with the unit. The list includes most common issues. Listed below are not result of defective unit, crafts or materials in the unit. If all troubleshooting steps has been exhausted and issue is still occurring, feel free to get in touch with Waykar Customer Service to get further assistance.

Problem	Reason	Method
Dehumidifier does not work	The power cord is unplugged.	Make sure that the unit's plug is inserted properly into the power outlet.
	Is the TankFull indicator blinking? (The tank is full or in a wrong position.)	Empty the water in the water tank and then reposition the tank.
	Is the room temperature above 95°F (35°C) or below 41°F (5°C).	This product does not apply to over hot or cold environment, the machine will automatically protection, it is a normal phenomenon.
	Is the room temperature between 41°F(5°C) and 68°F(20°C) ?	When running under lower ambient temperature, the machine will automatically defrost, it is a normal phenomenon. Wait until the defrost process finish, it will restart dehumidifying again.
	The dehumidifier is in the defrosting process.	It is normal the compressor ceases while defrosting process. Wait until the defrost process finish, it will restart dehumidifying again.
	Does the room humidity is lower than or reach the preset humidity level? (The room humidity has reached the preset humidity level, the dehumidifier enters into Standby Mode and the the LCD and indicators will flashing.)	Please set the humidity 5% decrease by degrees than the room humidity or set the humidity to 30%.
	There is prevent frequent start function in the machine. Dose the machine stop working just now?	Please wait for more than 3 minutes.
	Room humidity is low.	The dehumidifier is designed to work in the humidity range of 30% -80%. Above or below the work humidity range, it will not work.

# COMMON FAULTS AND SOLUTIONS

Dehumidifier does not dry the air as it should	The air filter is dirty.	Clean the air filter.
	Is the air inlet or air outlet obstructed?	Remove the obstruction from the air inlet or outlet.
	The dehumidifier size is too small for application.	Increase the quantity of dehumidifier. Or change a higher capacity dehumidifier.
	Poor air circulation.	Please leave about 7.9inch(20cm) around the product.
	Did not allow enough time to remove the moisture.	Allow enough time to remove the moisture. When first installed, allow at least 3-4 days to maintain the desired RH.
	The room has not been sealed properly.	Check that all doors, windows and other openings are securely closed.
	Room temperature is too low, or below 41°F (5°C)(The machine will not work and or poor dehumidify efficiency in low temperature	Please wait the temperature rises above 5°C or higher.
The dehumidifier makes loud noise when operating	The dehumidifier is not positioned level.	Move the machine to a horizontal position.
	Is there blocking around the air inlet? The air filter is clogged.	Clean up the dirty form the on the air outlet and intake.
	Is the filter installed correctly?	Please check whether the filter packing bag removed and install correctly.
Dehumidifier operates continuously	Check if the dehumidifier is in CONTINUOUS MODE.	Don't set the humidity too low. Typically, 40-50% are good settings to use.
	Room humidity is too high.	Change humidity settings. Or change a higher capacity dehumidifier.
	Doors and windows are open.	Ensure that all doors, windows and other openings are closed.

## COMMON FAULTS AND SOLUTIONS

Overflow of water on floor	Hose to connector or hose connection may be loose.	Connect the hose with the drain outlet tightly.
	The water bucket has not been installed properly.	Re-install the water bucket properly.
	The water tank 's float has been stuck.	Move the float and let it can be swung freely.
	The magnet on the float has come off.	Put the magnet in right position.

### Warning:

If the dehumidifier is still not working properly as expected and the troubleshooting steps or solutions above may not resolve the issue. Please unplug the power and shut down the dehumidifier then contact waykar customer service [support@waykar.com](mailto:support@waykar.com)



# SAFETY NOTE



Do not place unit on uneven surface.

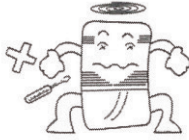

Do not insert any sharp objects into air inlet/airoutlet.

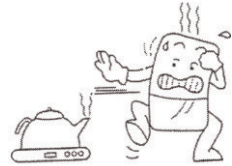

Do not operate unit near radiators, kettles or any object that releases steam.



Do not operate unit near windows or doors opening to the outdoor.



Do not obstruct air inlet and outlet.



Unplug power when the unit is not in use for an extended period.



Do not spray any liquid onto unit.



Do not put heavy objects on top of unit.



Wash the air filter once every 2 weeks with cold water. (Do not use water >40 or benzene)



When draining water continuously, make sure drain hose is not tangled.



Do not place filter directly under



Empty water tank before moving unit.

# TECHNICAL PARAMETERS

MODEL	PD100A
POWER SOURCE	120V ~ 60Hz
RATED POWER(95°F,90%RH)	200W
RATED CURRENT(95°F,90%RH)	1.8A
MOISTURE REMOVAL CAPACITY (65°F,60%RH)	8.4 Pints/Day(4L/Day)
MOISTURE REMOVAL(80 °F,60%RH)	12.3 Pints/Day(5.8L/Day)
MOISTURE REMOVAL(86 °F,80%RH)	21.8 Pints/Day(10.3L/Day)
MOISTURE REMOVAL(95 °F,90%RH)	29 Pints/Day(13.7L/Day)
INPUT POWER(65°F,60%RH)	125W
INPUT CURRENT(65°F,60%RH)	1.2A
IEF( 65°F,60%RH)	1.30 liters/kWh
MOTOR FLA	0.19A
MOTOR COMPRESSOR	RLA:1.7A LRA:10.0A
REFRIGERANT	R134a/4.4ozs(125g)
MAXIMUM ALLOWABLE PRESSURE	363 PSIG(2.5MPa)
HIGH PRESSURE	232 PSIG(1.6MPa)
LOW PRESSURE	90 PSIG(0.62MPa)
Water Tank Capacity	0.26 gal
Dimensions	11.22"*7.28"*18.5"
Weight	2.2LB

The Company reserves the right to change the product, the above parameters are subject to change without notice.

 **WARNING:**

This product can expose you to chemicals including Styrene and its compounds, which is known to the State of California to cause cancer and birth defects or other reproductive harm. For more information go to: [www.P65Warnings.ca.gov](http://www.P65Warnings.ca.gov)

# WARRANTY AND CONTACT US

## Warranty

---

Waykar offers a 12-month warranty to all of our products, newly purchased and unused, from Waykar or through an authorized reseller, together with the original proof of purchase when a defect occurred, wholly or substantially, or as a result of faulty manufacturing, parts or workmanship during the Warranty Period. The warranty does not apply if damage is caused by other factors, including without limitation of:

- (a) Normal wear and tear;
- (b) Abuse, mishandling, accident or failure to follow operating instructions;
- (c) Exposure to liquid or infiltration of foreign particles;
- (d) Servicing or modification of the product other than by Waykar.

These are our general terms for the warranty service, but we always urge our customers to reach out to us with any issue, regardless of warranty terms. If you experience an issue with a Waykar product, please contact us at [support@waykar.com](mailto:support@waykar.com), we will do our best to resolve it for you.

## Extend Your Warranty by 1 Year

---

Register your product at [www.waykar.com](http://www.waykar.com) to extend your 1-year warranty by an additional year.

\*Please filled out all required fields and include your order ID, Date of Purchased if applicable.

## Customer Support

---

If you have any questions or concerns about your product, please feel free to contact our expert support team. Waykar customer service is here to help!

### Waykar Office

13211, Spring Street Baldwin Park, CA, US

Email: [support@waykar.com](mailto:support@waykar.com)

Live Chat: [www.waykar.com](http://www.waykar.com)

### Support Hours

24 Hours available

\*Please have your order number before contacting customer support.

# waykar

For FAQs and more information please visit:  
[www.waykar.com](http://www.waykar.com)



@Waykar



@Waykar



@Waykar



@Waykar



(Scan the QR Code for Live Chat)

We would love to see our product being used and how it makes your day!! Your support means the world, Please tag us if you share a snap on your social media.

[www.waykar.com](http://www.waykar.com)