

Honeywell

Dehumidifier Owner's Manual

Read and save these instructions before use

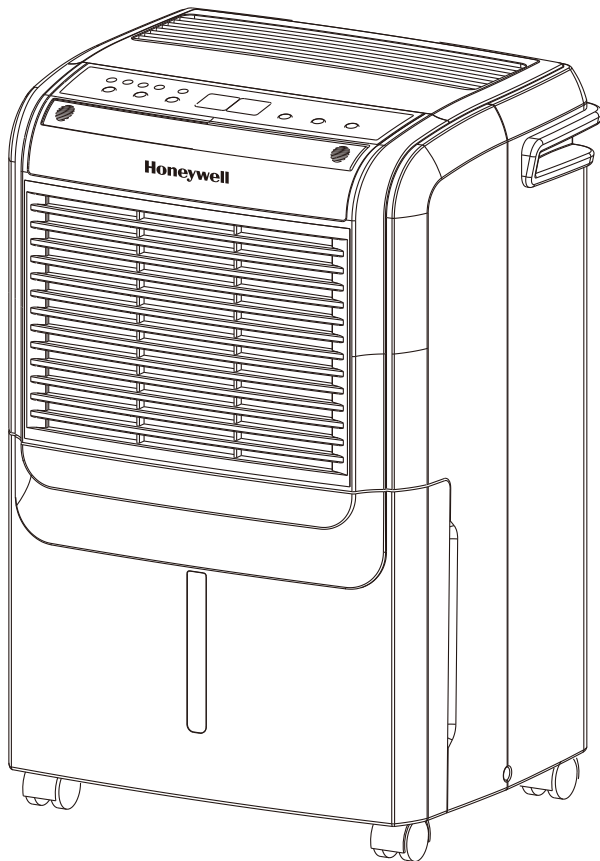

Model: DH50W / 70W

For product inquiries or support: www.jmatek.com

Customer Support:

1-800-474-2147

E-mail us at: info@jmatekna.us



ENERGY STAR® qualified units remove moisture with less energy than conventional dehumidifiers.

THANK YOU!

Thank you for purchasing a Honeywell dehumidifier. This User Manual is intended to provide you with important information needed to set up, operate, maintain and troubleshoot this product.

SAFETY RULES



WARNING -- READ AND SAVE THESE INSTRUCTIONS BEFORE USING THIS PRODUCT.

The user of electrical products may create hazards that include, but are not limited to injury, fire, electrical shock. Failure to follow these instructions may damage and/ or impair its operation and void the warranty.

When using electrical appliances, basic safety precautions should always be followed:

- **DO NOT** touch the dehumidifier or the electrical plug with wet hands.
- Check the household voltage to ensure it matches the appliance's specification.
- Before operating, remove all packaging material and check for any damage that may have occurred during shipping.
- **DO NOT** operate any product with a damaged cord or plug.
- **DO NOT** use an extension cord with this appliance.
- **DO NOT** run power cord under carpeting, or cover it with rugs or runners. Keep the cord away from areas where it may be tripped over.
- Always unplug the dehumidifier before emptying the water tank.
- The water collected in the tank must be discarded. The water should never be used for drinking.
- Always unplug the dehumidifier and remove the water from the water tank before cleaning, servicing or relocating the unit.
- Remove the power cord from the electrical receptacle by grasping and pulling on the power cord plug-end only, never pull the cord.
- This appliance has been manufactured for use in domestic environments and must not be used for other purposes.
- **DO NOT** use the product in areas where gasoline, paint or other flammable goods and objects are used or stored.
- This dehumidifier is designed for indoor residential applications only. It should not be used for commercial or industrial applications.
- **DO NOT** attempt to repair or adjust any electrical or mechanical functions of the dehumidifier, as this may cause danger and void the warranty.
- **DO NOT** cover the air inlet or outlet on the appliance as this may cause the unit to fail.
- **DO NOT** insert or allow objects to enter any ventilation or exhaust opening as this may damage the product and could cause electrical shock or fire.
- **DO NOT** let children play with this appliance, packaging or included plastic bag.
- If the unit is damaged or it malfunctions, do not continue to operate it. Unplug the product from the electrical outlet. Refer to the troubleshooting section and contact the customer support center.
- Always place the dehumidifier on a leveled floor.
- Never install the product near a bathtub or any water container.
- Store in a dry area, away from direct sunlight, when not in use.
- This appliance and its packaging materials are not intended for use by persons (including children or elderly) with reduced physical, sensory or mental capabilities, or lack of experience and knowledge, unless they have been given supervision or instructions concerning the use of the appliance by a person responsible for their safety.
- Always grip the side handles and keep the unit upright when transporting from room to room – **DO NOT** tilt the product on its side or upside-down.
- If the dehumidifier was transported tilted on its side, you must position it upright again and wait at least 4 hours before using it.
- **WARNING:** To reduce the risk of fire or electric shock, do not use this appliance with any solid state speed control device.

HOW A DEHUMIDIFIER WORKS

When the dehumidifier is switched ON, a fan pulls moisture-laden air into the dehumidifier where it passes through dehumidifying coils inside the unit. These coils condense moisture from the air and collect it in the water tank. The dry air is then exhausted from the dehumidifier. The air flows through the air vents of the dehumidifier into the room as dry, warm air.

IMPORTANT: The dehumidifier is designed to operate between 41°F (5°C) and 89°F (32°C). The dehumidifier's performance may be greatly reduced if room temperatures exceed this temperature range.

SELECTING A LOCATION (IMPORTANT)

- Before using the dehumidifier, place the unit UPRIGHT for at least 1 hour before use to allow the refrigerant to stabilize. If the unit was tilted on its side or upside-down during transportation, set the unit upright for 4 hours before use.
- For optimal efficiency, the dehumidifier must be operated in an enclosed area. Keep all doors, windows and other outside entrances to the room closed.
- Place the dehumidifier at least 12 inches (31cm) away from other objects (e.g. curtains or furniture) that may restrict airflow from the front or through the air vents of the unit.
- The dehumidifier must be positioned on a level floor.

IMPORTANT: The effectiveness of the dehumidifier can be influenced by different factors. One factor is the rate at which new, moisture-laden air enters the room and the amount of air circulating in and out of the area to be dehumidified. For example, if a door to a basement is constantly opened, letting new, moisture-laden air into the room, dehumidification will take longer than if the door was kept closed. If the dehumidifier is in a room with a storage closet or cabinets, it will have little or no effect in drying the inside of the storage closet or cabinets unless there is adequate circulation of air in and out of these places. To dehumidify these places, open the storage door or cabinet doors to allow air circulation. You may find that installing a second dehumidifier may be required for larger enclosed areas.

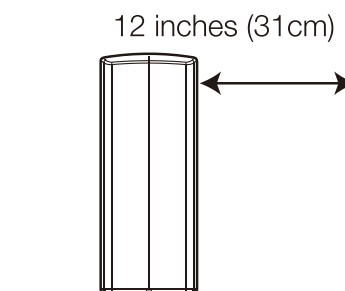
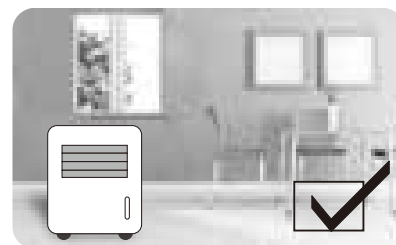

PARTS DESCRIPTION

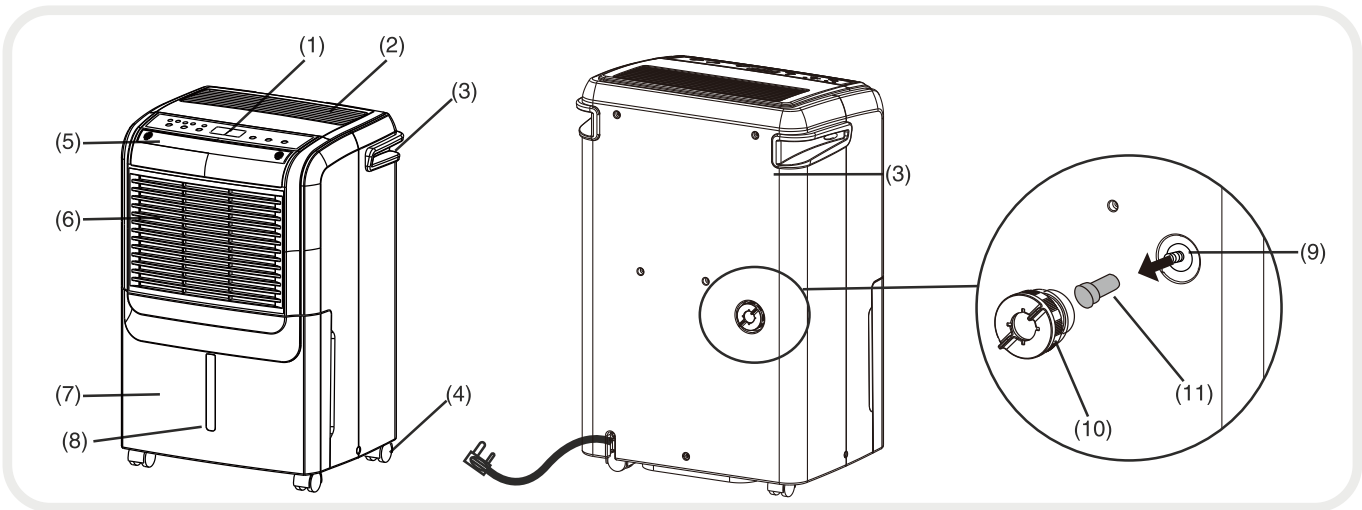

- | | | |
|----------------------------------|--------------------------|------------------------|
| 1) Control Panel | 5) Washable Air Filter | 9) Direct Drain Outlet |
| 2) Dehumidified Air Exhaust Vent | 6) Moist Air Intake | 10) Drain Cap |
| 3) Handle | 7) Water Tank | 11) Rubber Stopper |
| 4) Casters | 8) Water Level Indicator | |

USE & OPERATION

CONTROL PANEL

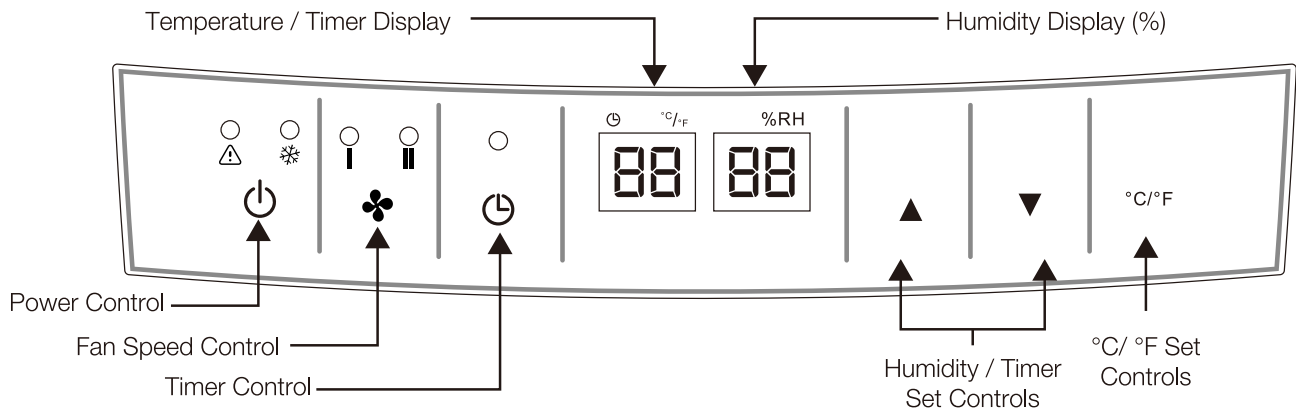

Power Control

Press  to switch the dehumidifier ON or OFF.

Water Tank Full Indicator Light

This illuminates when the Water Tank is full of water or if the Water Tank is not positioned properly on the unit. To switch off , empty the Water Tank and check that the tank is secured properly into place.

Defrost Light

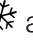
This indicates that the room temperature is too low. Increase the room temperature or wait until the temperature increases to switch off  and to turn the dehumidifier on again.

Fan Speed Control

Press to set the desired fan speed.

There are 2 fan speeds to select from: **High II / Low I**

A higher fan speed results in faster moisture removal.



CONTROL PANEL (CONTINUED)

Timer Control



The dehumidifier can be set to automatically switch ON or OFF after a selected period of time (between 1-24 hour intervals). The Timer hours selection is displayed on the Timer/Temperature Display Screen.

NOTE: Before setting the Timer control, make sure there is power to the unit.

Auto-Off Timer:

While the unit is running, first press  and then tap or hold the  or  to select the number of hours you want the unit to run before it switches off. The unit automatically switches off after the set time period has elapsed. You must repeat the Timer set up procedures to reset the Timer for next use, if needed.

Auto-On Timer:

When unit is in standby mode, press  and  or  to select the number of hours until you want the unit to automatically start running. The previous fan speed and humidity setting will be maintained. The unit will continue running until the water tank is full (unless the unit is set up for continuous draining) or until you switch it off manually.

NOTE: To cancel any Timer settings, simply press  and then tap or hold the  or  until the Timer display shows '0'.



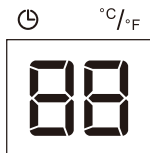

Temperature / Timer Display



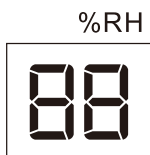

When the unit is switched ON, the Temperature / Timer Display shows the current room temperature. Pressing the Timer  temporarily switches the display to show the Timer setting (in hours) for 10 seconds, before reverting back to the temperature display

Humidity Control Setting



When the unit is switched ON, the Humidity Display shows the current humidity percentage. Press  or  to select your preferred humidity level. The humidity is adjusted in increments of 5% by pressing  or . The adjustable Relative Humidity (RH) range is between 30% RH to 90% RH. Ten seconds after setting the preferred humidity setting, the display will revert back to displaying the current humidity.

Recommended Settings: It is recommended to leave the unit running at 30% humidity at High Fan Speed during the first 2 to 3 days until damp odors are removed. After a few days when the Relative Humidity has been reduced to a more comfortable level, press  or  to choose a higher RH% that maintains a comfortable humidity level thereafter. A recommended healthy humidity level is between 40% and 50%

°C/ °F Display Options

Press  to change the Temperature Display from degrees Celcius °C to degrees Fahrenheit °F.

DRAINING THE WATER

WARNING: Always drain and discard water collected from dehumidification. The water is not clean and cannot be used for drinking.

1. Draining water collected in the Water Tank

The condensed water can be collected directly into the water tank. When the water tank is full, the dehumidifier will automatically shut OFF and ⚠ will illuminate on the control panel followed by a beeping sound.

IMPORTANT: Do not move the dehumidifier when the water tank is full as it will be heavy and can cause water spillage.

- 1.1 Locate the water tank at the front of the dehumidifier. Gently pull the water tank out and place it on the floor. Two stands located at the bottom of the water tank will automatically extend to help balance the tank on the floor.
- 1.2 Grip the handle inside the water tank and carry the water tank to a sink to empty.
- 1.3 Replace the empty water tank back into the front of the dehumidifier. Please make sure that the tank is properly positioned.

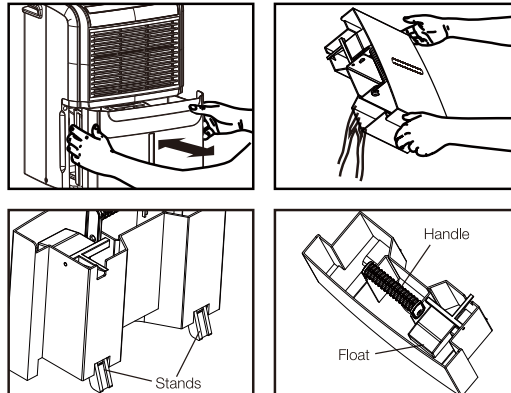

IMPORTANT: Improper alignment or positioning of the water tank will cause the unit to pause operation, the warning light on top of the dehumidifier will illuminate followed by a beeping sound, until the water tank is fitted properly.

NOTE: There is a Float inside the water tank that senses the water level to automatically stop dehumidification when the water tank is full. Make sure the float is positioned correctly inside the water tank by ensuring it lies level with the top edge of the water tank.

2. Continuous Water Drainage

For continuous water drainage, you will need a garden hose* and a suitable water drain (e.g. a sink or drain hole at floor level) near the dehumidifier.

- 2.1 Locate the drain outlet on the back of the unit.
- 2.2 Unscrew and remove both drain cap and rubber stopper.
- 2.3 Locate the female connector at one end of the garden hose. Insert the garden hose onto the drain outlet of the dehumidifier. Screw and tighten the garden hose connector onto the threaded part of the drain outlet, making sure the hose connector is secured to ensure there will be no leaks. If there are leaks, the hose and the drain outlet may not be connected properly. Disconnect, replace and tighten the garden hose connector again.
- 2.4 Position the other end of the garden hose in the sink or drain. Make sure the hose is not bent or kinked which might stop the water flow. Make sure the hose is secured over the drain and will not fall out of place causing unwanted water spillage.

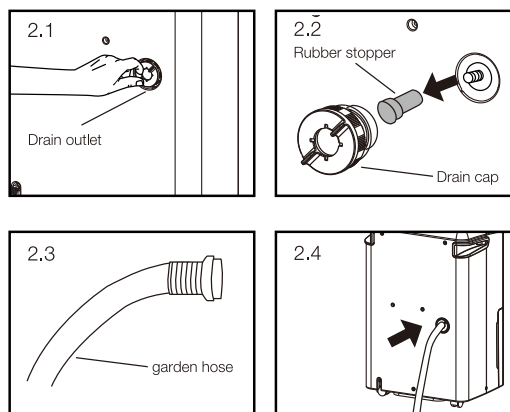

IMPORTANT: Make sure water can flow down the garden hose by keeping the hose angled down and free of bends or kinks.

IMPORTANT: If you stop using the continuous drain function, the drain cap and rubber stopper must be replaced before use to prevent leakage.

*The garden hose is NOT supplied.

CLEANING & MAINTENANCE

WARNING: Always switch OFF the dehumidifier and unplug it from the electrical outlet before attempting any cleaning or maintenance of this product.

Appliance Maintenance:

- Switch OFF the appliance before disconnecting the power supply.
- Only use a soft cloth to clean the appliance.

Air Filter Maintenance:

The Air Filter located at the top of the unit helps to remove dust particles from the air. A dirty filter blocked by dust particles can reduce the efficiency of the dehumidifier. For optimum dehumidification, it is recommended to clean the air filter every 2 weeks:

1. Switch OFF the dehumidifier. Press down on the air filter with 2 hands to release the air filter from the top of the unit.
2. Rinse the air filter under running water, or vacuum away the dust with a vacuum cleaner.
3. After cleaning the air filter, dry in a cool, shaded place, then carefully reinstall into the unit.

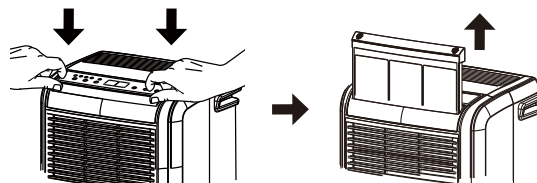

End of Season Storage & Maintenance:

If the appliance will not be used for an extended period of time:



- Switch OFF the unit and unplug from the electrical power outlet.
- Empty the water tank and let it dry. If your dehumidifier is connected to the continuous drain hose, you must disconnect the hose, dry and then replace the drain cap and rubber stopper back into the drain outlet.
- Remove the air filter and clean with water. Let the air filter dry and reinstall back into the unit.
- Make sure all parts of the dehumidifier and accessories are dry before storage.
- Cover the dehumidifier with a cloth/ plastic bag before storage, to protect the surface from dust and scratches.
- It is recommended to coil the power cord and store it off the floor to ensure it is protected from bends and kinks.
- Store the unit upright in a dry location, away from direct sunlight.

TROUBLESHOOTING GUIDE

The following troubleshooting guide addresses the most common problems. If problems persist, call customer service.

PROBLEM	POSSIBLE CAUSE	SOLUTION
Dehumidifier does not start	No electricity.	Check for power.
	The power cord is not properly plugged in.	Remove and reconnect the power cord.
	The safety switch activated on the electrical plug.	Reset the safety switch and wait for 3 minutes to pass. Contact customer service if problem persists.

TROUBLESHOOTING GUIDE (CONTINUED)

PROBLEM	POSSIBLE CAUSE	SOLUTION
Unit runs but the humidity level does not decrease	The humidity level setting is too high.	Decrease the humidity level setting.
	A door or window is open, letting in new moisture.	Make sure all windows or doors to the outside are closed and tightly sealed.
	There are other sources of humidity in the room (e.g. boiling water in pot).	Switch on the dehumidifier when these sources are not present.
	The temperature in the room is too low.	The dehumidifier is designed to operate between 41°F (5°C) and 89°F (32°C). Moisture removal is greatly reduced if room temperatures exceed this temperature range.
	The air filter is dirty/ blocked.	Clean the air filter.
	Air outlet or intake is blocked.	Remove blockage.
Dehumidifier runs constantly/ does not stop	Area to be dehumidified is too large.	The capacity of your dehumidifier may not be adequate for the room it is used in. It is recommended to add an extra dehumidifier for large areas.
	A door or window is open, letting in new moisture.	Make sure all windows or doors to the outside are closed and tightly sealed.
Water Tank Full  is illuminated and the unit is beeping	The water tank is full.	Empty the water tank.
	The water tank is not in the correct position.	Position the water tank correctly into the unit. Unit will not operate until the water tank is secure in place.
Defrost  is illuminated	The temperature of the room is too low.	The dehumidifier may not work effectively in low temperature environments. Increase the temperature of the room or wait until the temperature increases to use the dehumidifier.
Frost appears on the coils	Dehumidifier has been recently turned on in low room temperatures (usually below 41°F (5°C)).	This is normal. Frost will disappear in an hour or so after the dehumidifier is switched OFF.
Water on the floor	The garden hose/ drain hose may be loose.	Check the connections between the hose and the drain outlet on the unit. See Continuous Water Drainage section.
	You intended to use the water tank to collect water but the continuous drain hose is still connected.	Disconnect the hose and replace the rubber stopper and drain cap if using the water tank to collect water. See Continuous Water Drainage section.
Noise	Fan is working.	Wind from the fan can create sounds during operation. This is a normal sound.

Description of Product	Dehumidifiers	
Model	DH50W	DH70W
Voltage/Frequency	115 V~ 60 Hz	115 V~ 60 Hz
Power Consumption	515W	820W
Dehumidifying capacity	50 pints / 24 hours	70 pints / 24 hours
Refrigerant Type	R-410A	R-410A
Timer	24 hour (ON / OFF)	24 hour (ON / OFF)
Dimensions (W) x (D) x (H)	15.3 x 11.1 x 23.6 inches / 389 x 282 x 600 mm	15.3 x 11.1 x 23.6 inches / 389 x 282 x 600 mm
Weight	43 lbs / 19.5 kgs	43 lbs / 19.5 kgs

Electrical products should be properly disposed of. Please recycle where facilities exist. Check with your local authority or retailer for recycling.



JMATEK North America LLC
Mahwah, New Jersey 07495 USA
Phone: 1-800-474-2147
Email: jmatekna@info.us
Web: www.jmatek.com

Made in China
October 2014
© 2014 AirTek Int'l Corp. Ltd. All rights reserved.
The Honeywell Trademark is used under license from
Honeywell International Inc.
Honeywell International Inc. makes no representations
or warranties with respect to this product.
This product is manufactured by Airtek Int'l Corp. Ltd.

Honeywell