

This Is A Manual.

Moisture Maniac Dehumidifier

Introduction

Thanks for your purchasing our MD8581 MD8582 dehumidifier. This User Manual is meant to offer you a brief walk-through of the device's features and usage protocols. We hope you find this manual helpful. For additional information and technical support, please feel encouraged to contact us.

Important Instructions

KEEP IN AN UPRIGHT POSITION AT ALL TIMES, EVEN WHEN NOT IN USE. ENSURE UNIT IS PROPERLY LEVELED BEFORE USING.

INTENDED USE

This device is intended for use in the removal of excess moisture from small rooms, such as studies, walk-in closets, and bathrooms. Other than the removable water tank, this device is not user serviceable and should not be disassembled. Any use other than that described above will lead to damage to the product and may present additional risks.

How Does It Work?

The Dehumidifier works by way of thermoelectric cooling, which uses what's known as the Peltier effect to create a heat flux between the junction of two different types of materials. Using no compressors or moving parts, the device quietly pulls moisture from the air around it, removing muskiness and dampness from the room.

Important Safety Instructions

If damage occurs as a result of non-compliance with these operating instructions, manufacturer's guarantee will be voided.

- In case of a power outage, please wait 30 minutes before turning the unit back on.
- Keep unit in upright position whenever in use.
- To avoid electric shock, avoid opening unit.
- Always turn device off when not in use.
- Avoid using power adapter in excessively wet areas.
- Ensure that inlet and outlet grills are unobstructed.
- Use both hands when handling unit to avoid tilting.
- Keep device away from reach of children.

Parts List

1. Air inlet
2. Air outlet
3. On/Off button
4. Humidity now
5. 'On' LED
6. 'Full' LED
7. Humidity Control Button -Decrease humidity level
8. Humidity Control Button -Increase humidity level
9. Drain hole
10. Float switch
11. DC power socket
12. Water tank
13. Rubber feet
14. AC/DC switching mode power supply
15. AC power plug
16. DC power jack

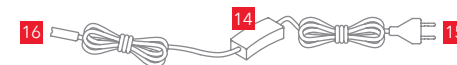
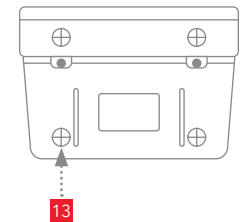
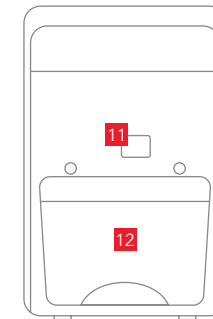
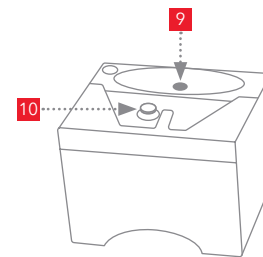
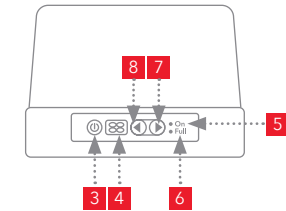
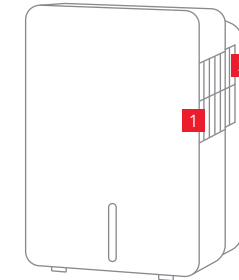

Operating Instructions

1. Connect the DC power jack (16) to the DC power socket (11). Then, connect AC power jack (15) to 100~240V/50Hz power socket.
2. Press the On/Off button (3). The machine starts working and the Green light is on. The air flow is expelled from the outlet (2). (Fig 1)
3. Press the On/Off button (3). Turn off the machine and the green light will shut off. When not in use for a long period of time, pull out the ac power plug. (Fig2)
4. When the water tank is full, the machine's water level sensor controls the automatic shutdown. Yellow light will turn on to dump the recycled water. (Fig 3)
5. Please turn off the machine before pouring water out. Please put the water tank in the correct position after pouring water.
6. If you need to continue to dehumidify, please restart the machine.

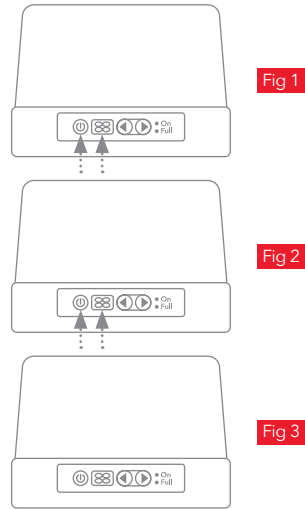

Setting Relative Humidity Levels

The Dehumidifier features an advanced humidistat function. Dehumidifiers without a humidistat stay on and work hard non-stop even if RH levels drop as low as 20%. This wastes energy and wears out the power adapters. With the MD858 Dehumidifier's humidistat function, you can set your desired relative humidity level in the range of 20%-80%. When RH levels increase beyond your set level by a value of 5%, the machine automatically turns on. When RH levels decrease below your set level by a value of 5%, the machine automatically turns off. By default, the unit is set to 50% RH.

TO SET YOUR DESIRED LEVEL:

1. Toggle On/Off Switch (3) to On position.
2. Wait a few seconds until RH Level Display (4) reads current RH level.
3. Depress the RH Up/Down Buttons (7) or (8) to select your desired RH level.
4. Display will flash for ten seconds, then revert to showing the current environment's RH level.

Emptying The Water Tank

1. The Dehumidifier will automatically turn off when tank is full.
2. The Yellow "Full" LED (6) will turn on.
3. Before removing water tank, toggle On/Off Switch (3) to Off position.
4. Remove the water tank.
5. Pour collected water out from the tank into sink or toilet.
6. Reinsert plug and slide tank back into device until it clicks.
7. Device is now ready for use again.

Cleaning and Maintenance

- Always turn Dehumidifier off and disconnect power cord before cleaning unit.
- Use a soft piece of cloth to cleanse the surface of the unit, and to clean the air inlet grills, use a soft-bristled brush to remove any dust.

Warranty Information

Vremi offers a 12-month warranty on all of our products purchased new and unused from Vremi LLC or an authorized reseller, with an original proof of purchase and where a defect has arisen, wholly or substantially, as a result of faulty manufacturing, parts or workmanship during the Warranty Period. The warranty does not apply where damage is caused by other factors, including but without limitation: (a) normal wear and tear; (b) abuse, mishandling, accident or failure to follow operating instructions; (c) exposure to liquid or infiltration of foreign particles; (d) servicing or modification of the product other than by Vremi. These are our general terms for the warranty service, but we always urge our customers to reach out to us with any issue, regardless of warranty terms. If you experience an issue with a Vremi product, please contact us at support@vremi.com, and we will do our best to resolve it for you.

E-Waste Recycling

This marking indicates that this item should not be thrown out with other household wastes. To prevent possible harm to the environment or human health from electronic waste disposal, recycle him responsibly so he can come back as a toaster someday. For assistance on proper disposal, call 1-800-8-BATTERY.

NOTE: This equipment has been tested and found to comply with the limits for a Class B digital device, pursuant to part 15 of the FCC Rules. These limits are designed to provide reasonable protection against harmful interference in a residential installation. This equipment generates, uses and can radiate radio frequency energy and, if not installed and used in accordance with the instructions, may cause harmful interference to radio communications. However, there is no guarantee that interference will not occur in a particular installation. If this equipment does cause harmful interference to radio or television reception, which can be determined by turning the equipment off and on, the user is encouraged to try to correct the interference by one or more of the following measures:

- Reorient or relocate the receiving antenna.
- Increase the separation between the equipment and receiver.
- Connect the equipment into an outlet on a circuit different from that to which the receiver is connected.
- Consult the dealer or an experienced radio/ TV technician for help.

Product Only:



Power Adapter Only:



Drop Us A Line

 CHAT WITH US

vremi.com/chat
Mon-Fri 10AM-5PM EST

 CALL US

(646) - 490 - 9904
Mon-Fri 10AM-5PM EST

 EMAIL US

support@vremi.com
We respond within 12 hours



vremi.com